

Beck
8/31/78

Pitkaik. FAA Cabin

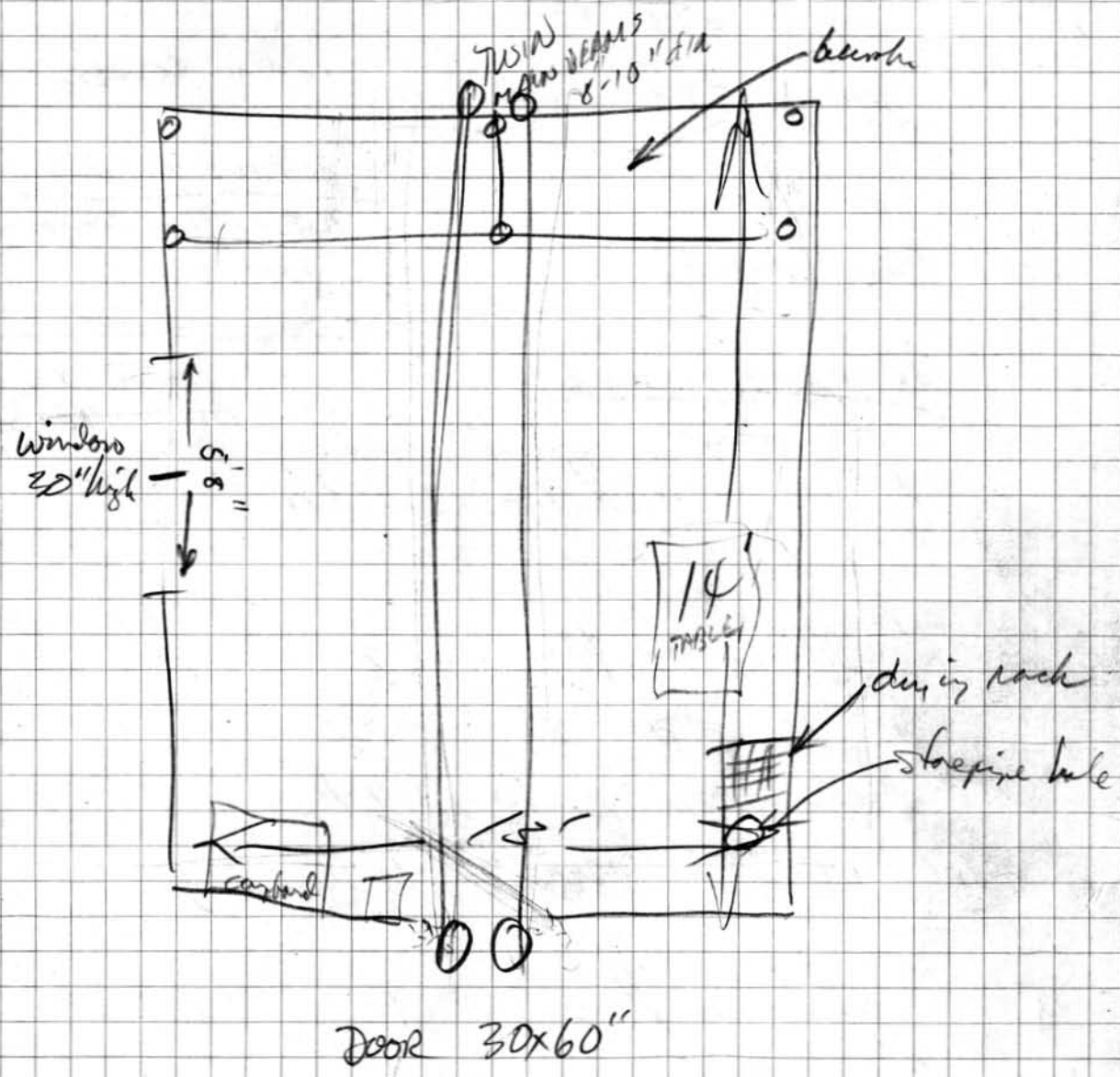

- Cabin needs to be signed -

{ 2 - 3 1/4" x 2 3/4" window frames needed }

{ shutter needed over outside of window }

{ logs need treating - top logs rotting, butt ends rotting badly }

{ Door needs a latch }

to Ref window on log:

Frank Turner

Feb 15, 1944

Jan 15, 1943

Dec 1, 1966

Dick Pf Bee E

Magazines on bunk:

Flight Mag Jul 1944

" " Nov 16, 1940

Air Trails Apr 1943

Colliers Oct 16, 1943

Jan 8, 1944

Newsweek Jan 10, 1944

" " Mar 21, 1936

Sat Eve Post Oct 6 1945

Time Feb 21, 1944

Wood crate attached to wall near cupboard cabinet

" Perry's W. Wash Eggs

Perry Bros, Seattle "

On bank post

July, 1943 (scratched in twice)

Peter Jensen - CAA

Cardboard on walls

Natl Fire Company

1000 4th Ave So, Seattle, Wash.
to Eugene Tibbo, McBeath

One to: Widman of Tibbo
McBeath

Pitkin F. Allen

8/3/78

Flora line poles approx 4" dia cross to boards -
some are rotten and need replaced
Flora boards 8" wide x 1" (sawn boards (not planed))

Table 29 x 64 (top down of frame)
32" high (needs boards)

Cupboard (30 1/2" x 48" (needs board top)
Cabinet (needs 8" x 48 1/2" shelf (rough saw - green))

Roof of 6-8" poles w/ poles on top over moss
Diagonal braces inside

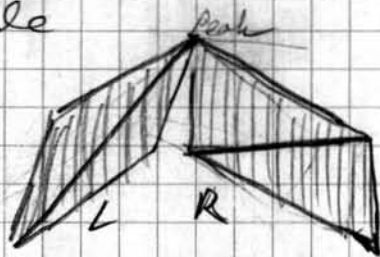

Bank 80" x 33" - ?

3 need boards 9 1/2" x 1" x 80"