

IDITAROD TRAIL SHELTER CABINS

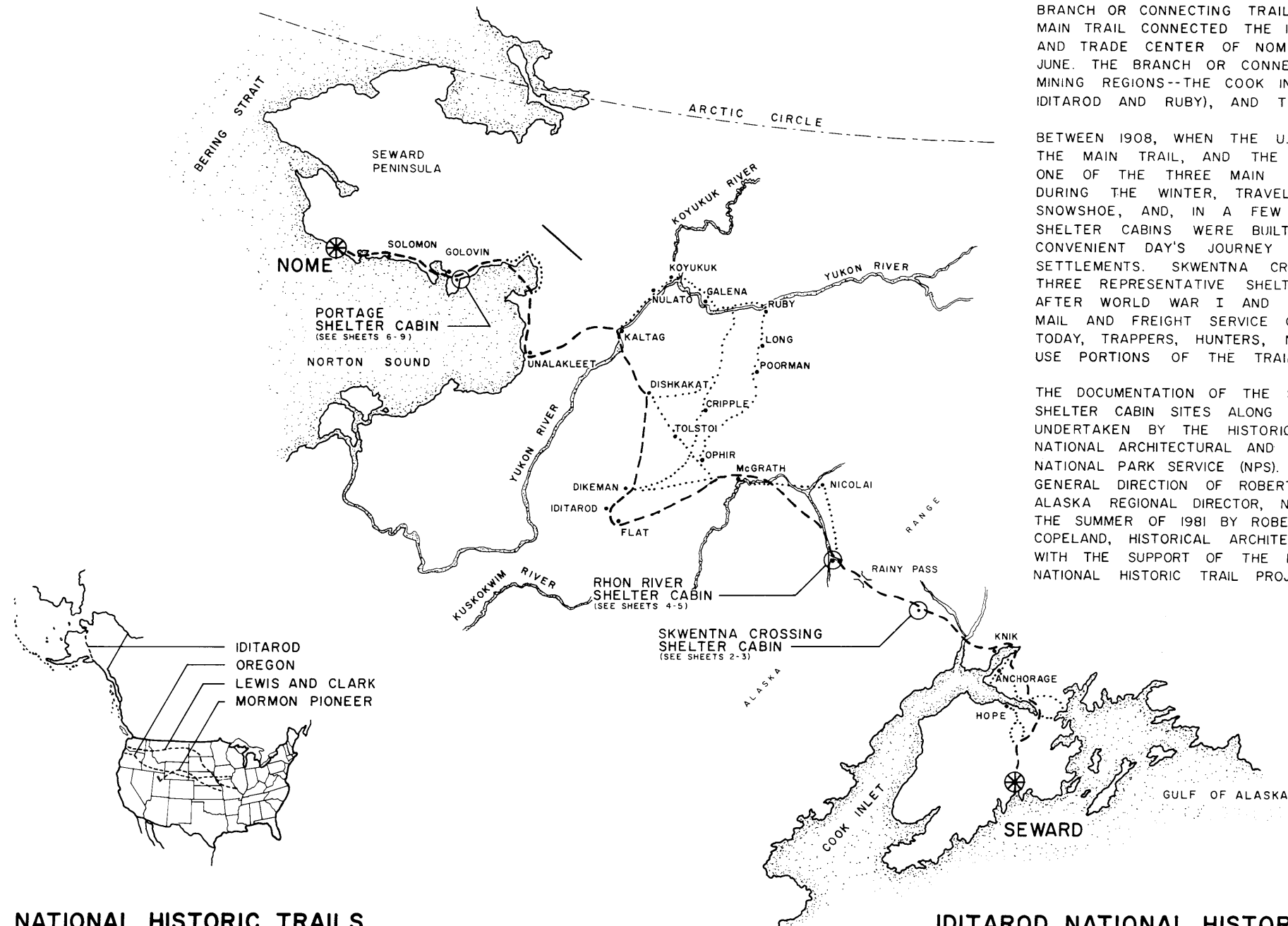

THE IDITAROD TRAIL CONSISTED OF A 938 MILE MAIN TRAIL AND NUMEROUS BRANCH OR CONNECTING TRAILS FOR A TOTAL OF SOME 2264 MILES. THE MAIN TRAIL CONNECTED THE ICE-FREE PORT OF SEWARD WITH THE MINING AND TRADE CENTER OF NOME, AN ICE-LOCKED PORT FROM OCTOBER TO JUNE. THE BRANCH OR CONNECTING TRAILS TAPPED THREE MAJOR ALASKAN MINING REGIONS--THE COOK INLET COUNTRY, THE INLAND EMPIRE (BETWEEN IDITAROD AND RUBY), AND THE SEWARD PENINSULA.

BETWEEN 1908, WHEN THE U.S. ARMY'S ALASKA ROAD COMMISSION BLAZED THE MAIN TRAIL, AND THE 1930'S, THE IDITAROD TRAIL SERVED AS ONE OF THE THREE MAIN CROSS-ALASKA LAND ROUTES. USED PRIMARILY DURING THE WINTER, TRAVELERS CROSSED THE TRAIL BY DOGSLED, SNOWSHOE, AND, IN A FEW SEGMENTS, BOBSLED. ROADHOUSES AND SHELTER CABINS WERE BUILT APPROXIMATELY EVERY TWENTY MILES, A CONVENIENT DAY'S JOURNEY APART, AND SERVED THE MUSHERS BETWEEN SETTLEMENTS. SKWENTNA CROSSING, RHON RIVER, AND PORTAGE ARE THREE REPRESENTATIVE SHELTER CABINS. THE DECLINE OF MINING AFTER WORLD WAR I AND THE INTRODUCTION OF THE AIRPLANE FOR MAIL AND FREIGHT SERVICE CAUSED THE DECREASE OF TRAIL USE. TODAY, TRAPPERS, HUNTERS, NATIVES, AND DOGSLEDDERS CONTINUE TO USE PORTIONS OF THE TRAIL.

THE DOCUMENTATION OF THE SKWENTNA CROSSING, RHON RIVER AND PORTAGE SHELTER CABIN SITES ALONG THE IDITAROD NATIONAL HISTORIC TRAIL WAS UNDERTAKEN BY THE HISTORIC AMERICAN BUILDINGS SURVEY (HABS) OF THE NATIONAL ARCHITECTURAL AND ENGINEERING RECORD (NAER), A DIVISION OF THE NATIONAL PARK SERVICE (NPS). THE PROJECT WAS EXECUTED UNDER THE GENERAL DIRECTION OF ROBERT J. KAPSCH, CHIEF OF NAER AND JOHN COOK, ALASKA REGIONAL DIRECTOR, NPS. RECORDING WAS CARRIED OUT DURING THE SUMMER OF 1981 BY ROBERT SPUDE, PROJECT DIRECTOR, RANDALL W. COPELAND, HISTORICAL ARCHITECT AND WALTER SMALLING, PHOTOGRAPHER, WITH THE SUPPORT OF THE BUREAU OF LAND MANAGEMENT'S IDITAROD NATIONAL HISTORIC TRAIL PROJECT TEAM.

NATIONAL HISTORIC TRAILS

DESIGNATED UNDER THE NATIONAL TRAIL SYSTEM ACT, PL. 90-543 AND AS AMENDED BY PL. 95-625, NOVEMBER 10, 1978.

IDITAROD NATIONAL HISTORIC TRAIL

SCALE: 1" = 40 MILES
0 50 100 200 MILES
0 50 100 200 KILOMETERS

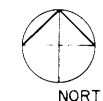

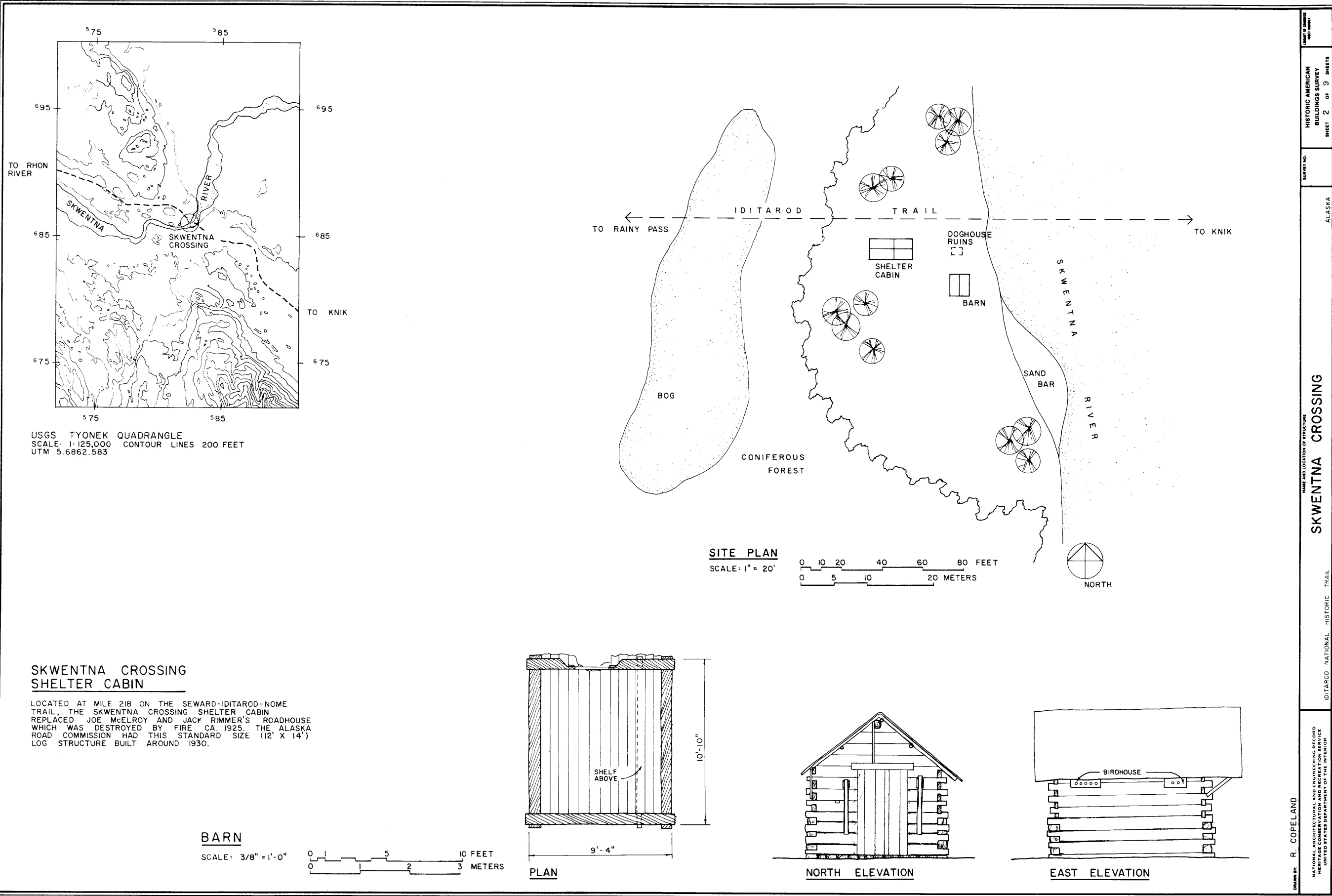

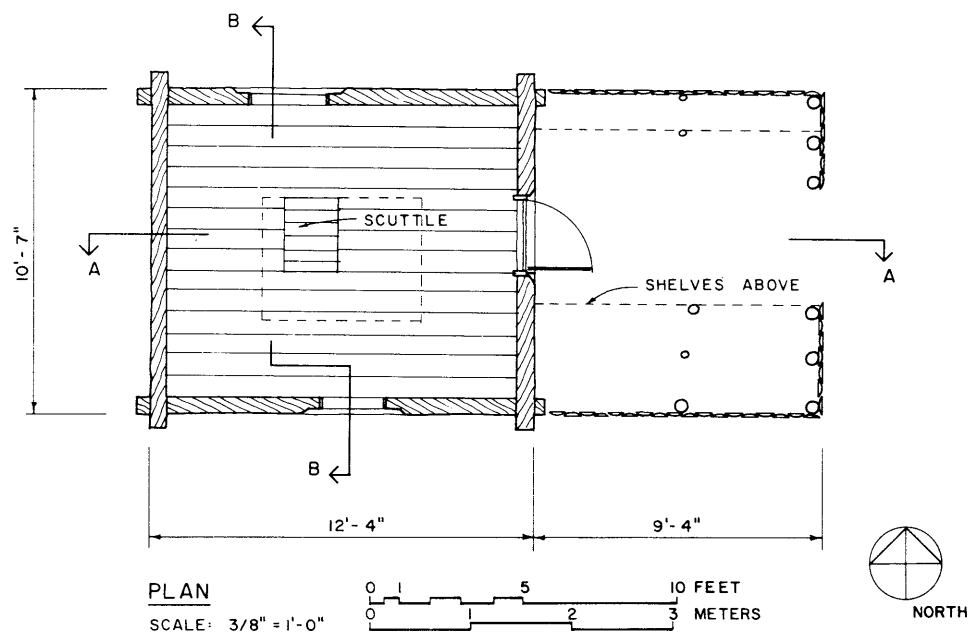

MATERIALS NOTE
ORIGINAL STRUCTURE:
 WALLS: 6"± MODIFIED NOTCHED LOGS, HEWN ON INTERIOR.
 MOSS CHINKING.
 FLOOR: 3/4" X 8" PLANKS.
 CEILING: 4" X 24" SHAKES AND OATMEAL PAPER.
 ROOF: CORRUGATED METAL OVER SHAKES ON 1" X VARIED WIDTH SHEATHING.
FRONT ADDITION:
 WALLS: 1 1/2" X 8" MILL SLAB SIDING.
 FLOOR: DIRT.
 CEILING: UNFINISHED.
 ROOF: CORRUGATED METAL OVER RANDOM WIDTH SHEATHING.

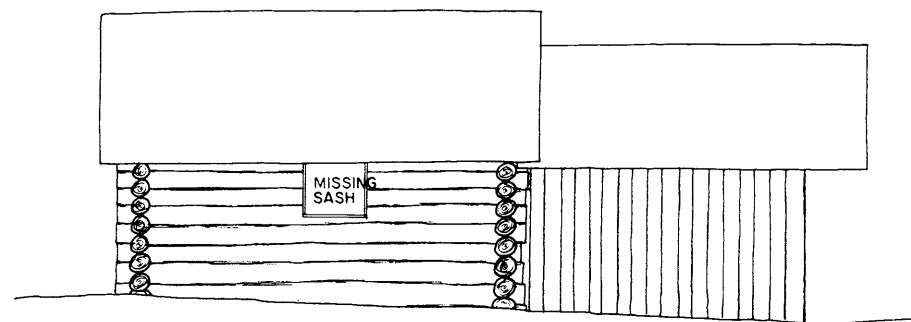

SOUTH ELEVATION

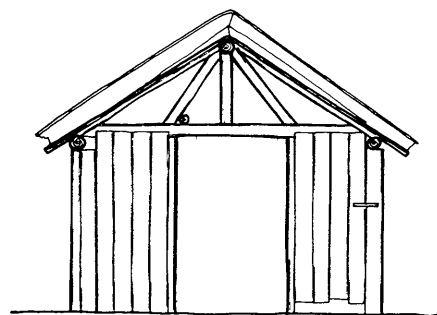

EAST ELEVATION

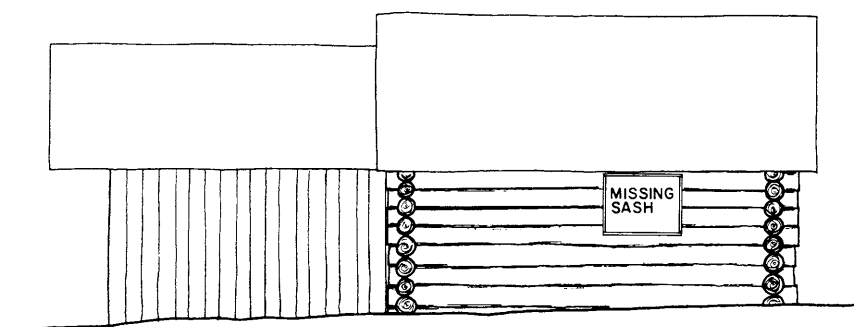

NORTH ELEVATION

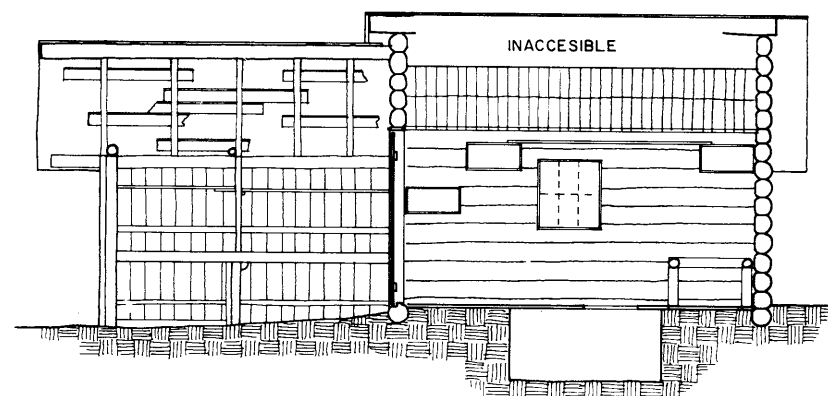

SECTION AA

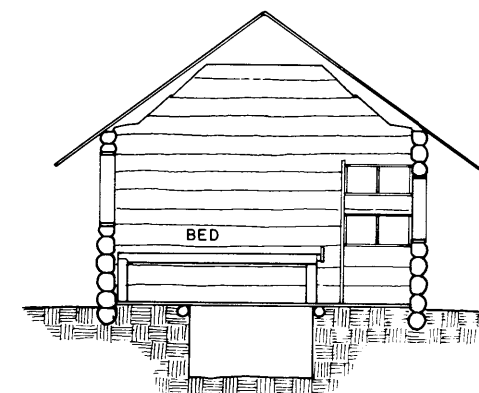

SECTION BB

DRAWN BY: R. COPELAND

NATIONAL ARCHITECTURAL AND ENGINEERING RECORD
 HERITAGE CONSERVATION AND RECREATION SERVICE
 UNITED STATES DEPARTMENT OF THE INTERIOR

IDITAROD NATIONAL HISTORIC TRAIL

SKWENTNA CROSSING SHELTER CABIN

ALASKA

HISTORIC AMERICAN
 BUILDINGS SURVEY
 SHEET 3 OF 9 SHEETS

DATE OF SURVEY
 MAY 1987

MATERIALS NOTE

WALLS: 10"± V-NOTCHED LOGS,
HEWN ON INTERIOR.
MOSS CHINKING.
FLOOR: DIRT FORMER WOOD
FLOOR IS MISSING.
CEILING: UNFINISHED.
ROOF: SOD OVER 4"±
HEWN LOGS.

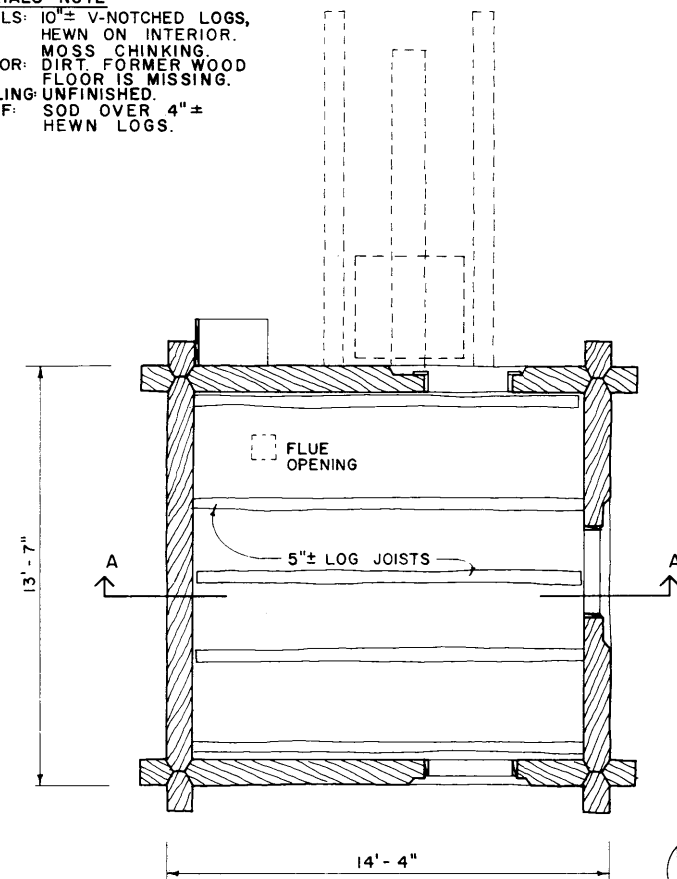

PLAN

SCALE: 3/8" = 1' - 0"

0 1 5 10 FEET
0 2 3 METERS

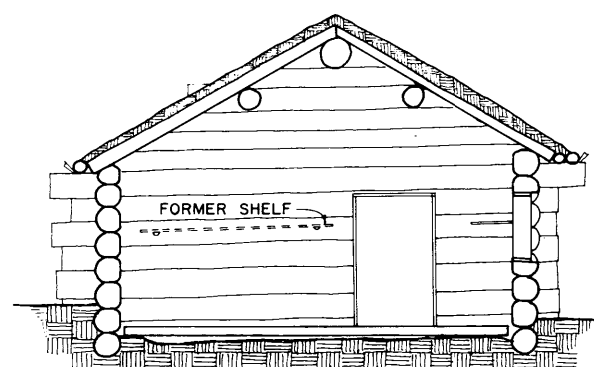

SECTION AA

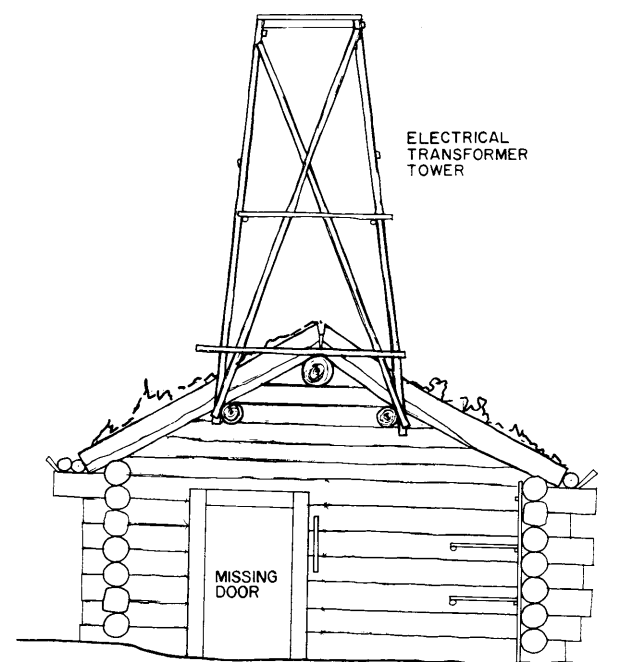

NORTH ELEVATION

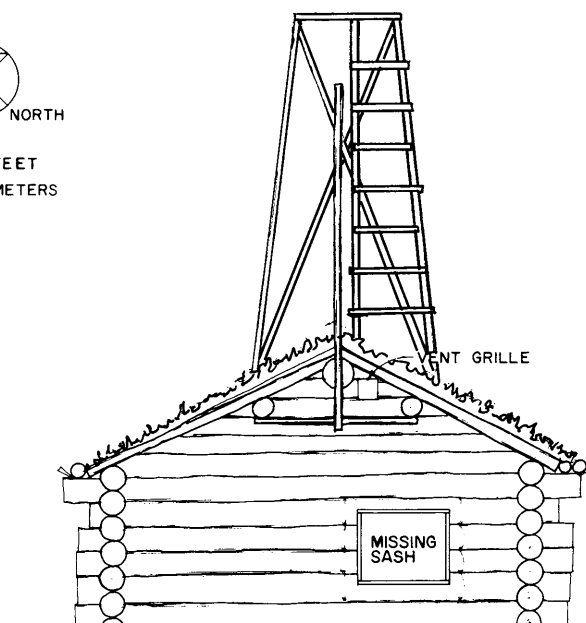

SOUTH ELEVATION

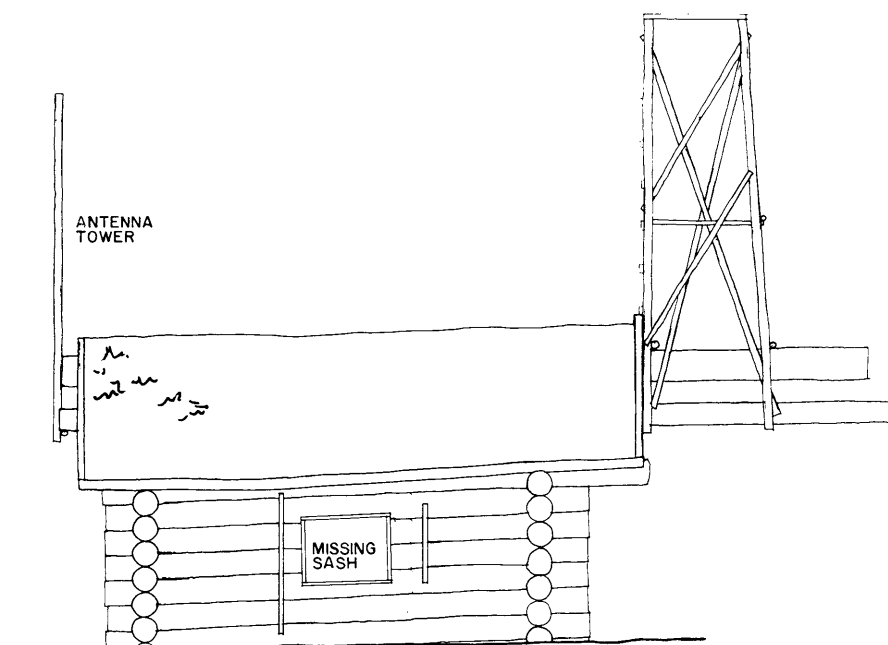

EAST ELEVATION

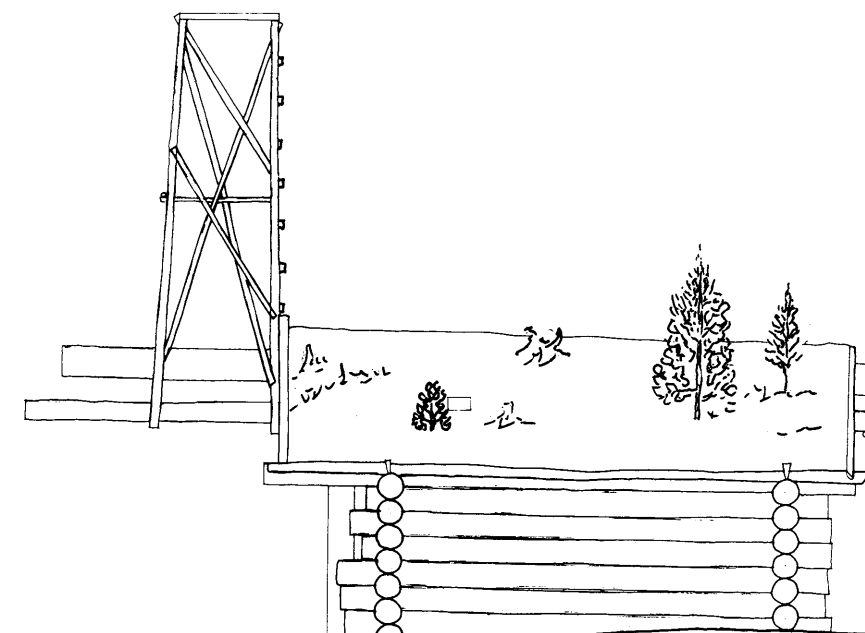

WEST ELEVATION

DRAWN BY: R. COPELAND

NATIONAL ARCHITECTURAL AND ENGINEERING RECORD
HERITAGE CONSERVATION AND RECREATION SERVICE
UNITED STATES DEPARTMENT OF THE INTERIOR

IDITAROD NATIONAL HISTORIC TRAIL

RHON RIVER SHELTER CABIN

ALASKA

SURVEY NO.

HISTORIC AMERICAN
BUILDINGS SURVEY
SHEET 5 OF 9 SHEETS

DATE OF SURVEY
1981, 1982

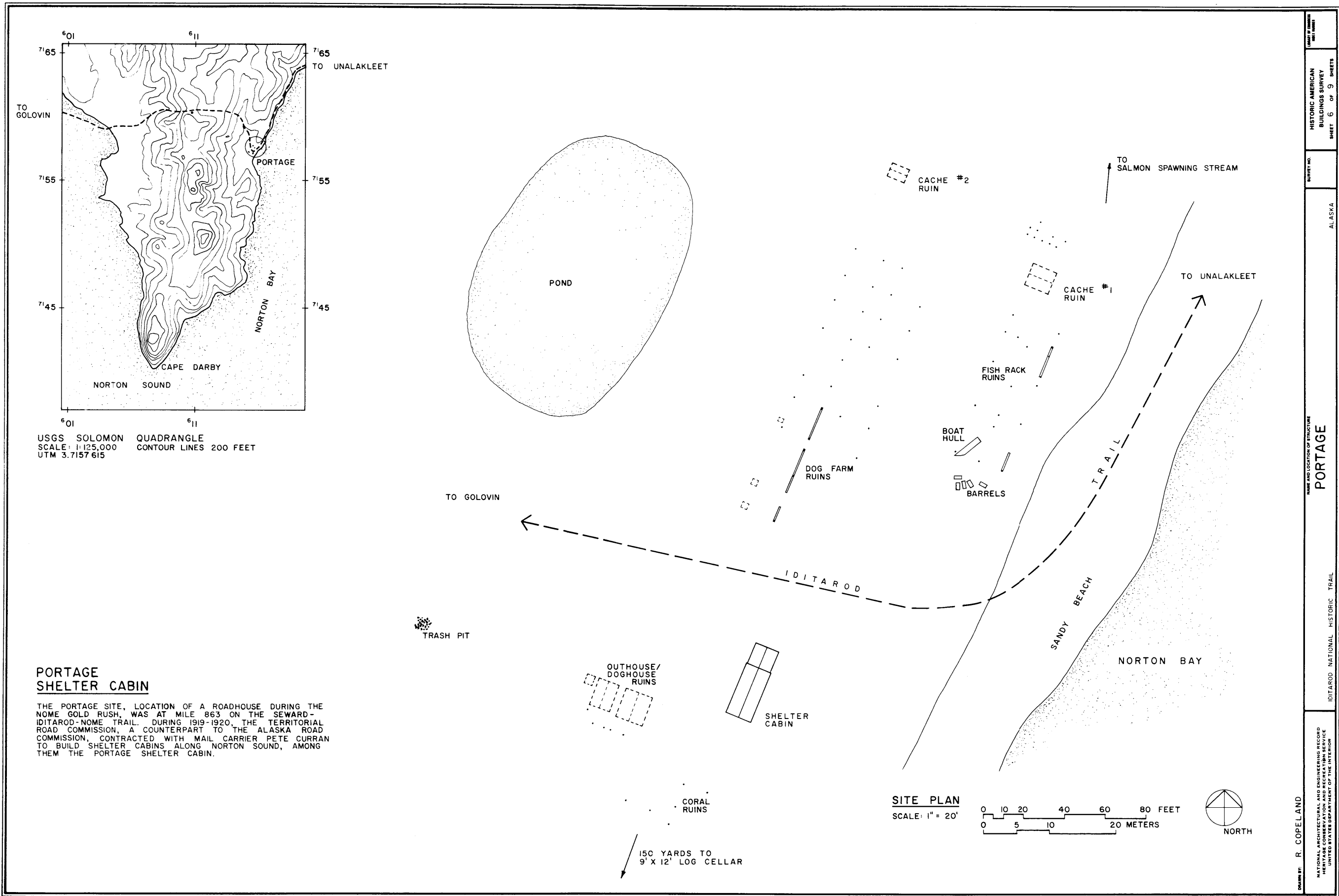

MATERIALS NOTE

WALLS: 10" ± V-NOTCHED LOGS,
HEWN ON INTERIOR.
MOSS CHINKING.
FLOOR: DIRT FORMER WOOD
FLOOR IS MISSING.
CEILING: UNFINISHED.
ROOF: SOD OVER 4" ±
HEWN LOGS.

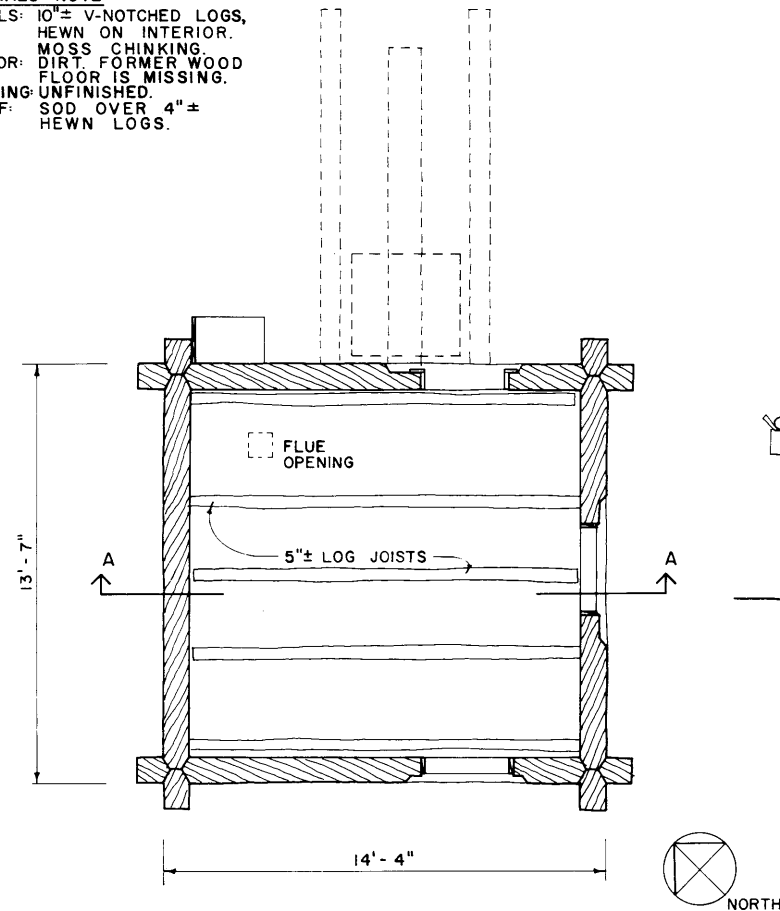

PLAN

SCALE: 3/8" = 1'-0"

0 1 5 10 FEET
0 1 2 3 METERS

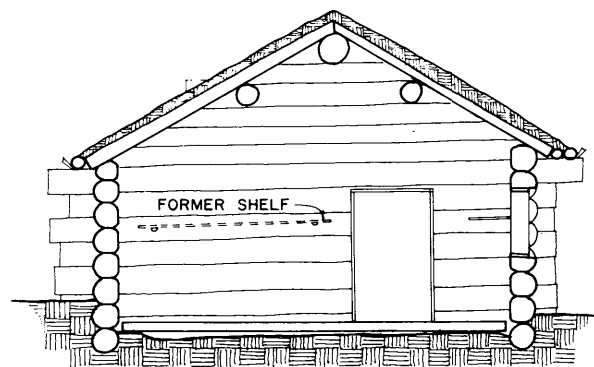

SECTION AA

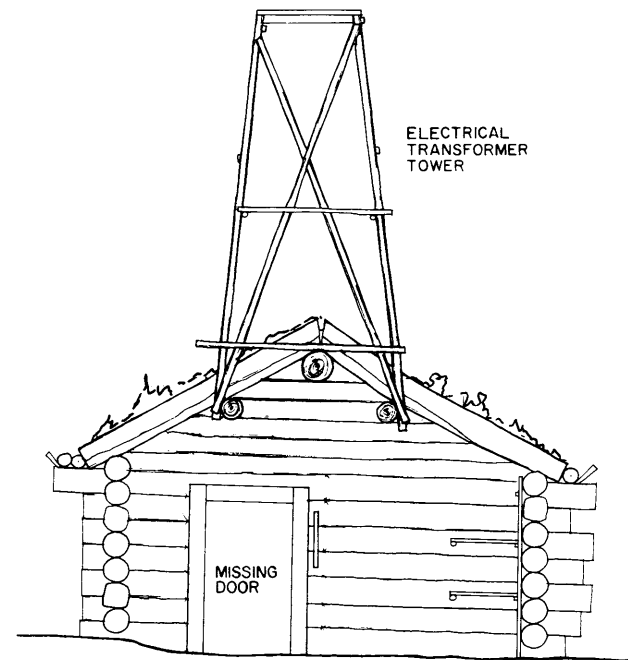

NORTH ELEVATION

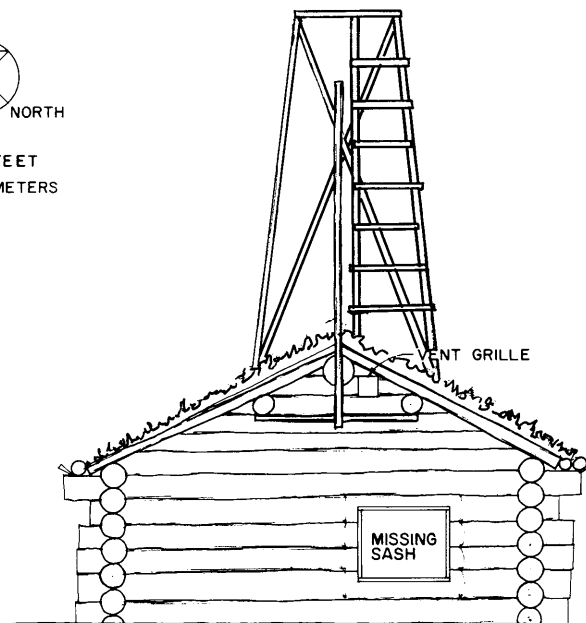

SOUTH ELEVATION

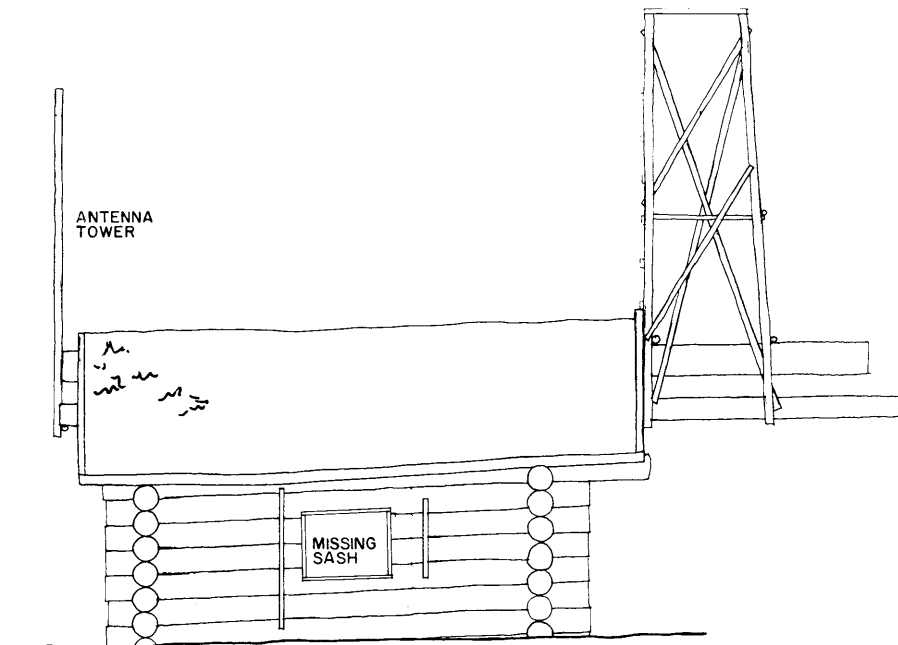

EAST ELEVATION

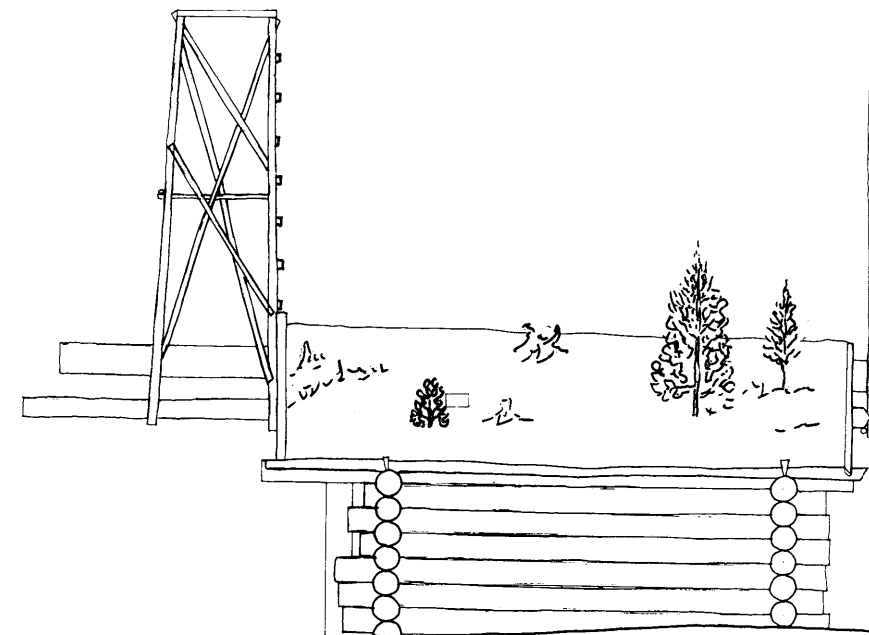

WEST ELEVATION

DRAWN BY: R. COPELAND

NATIONAL ARCHITECTURAL AND ENGINEERING RECORD
HERITAGE CONSERVATION AND RECREATION SERVICE
UNITED STATES DEPARTMENT OF THE INTERIOR

IDITAROD NATIONAL HISTORIC TRAIL

RHON RIVER SHELTER CABIN

ALASKA

SURVEY NO.

HISTORIC AMERICAN
BUILDINGS SURVEY
SHEET 5 OF 9 SHEETS

DATE OF SURVEY
1981

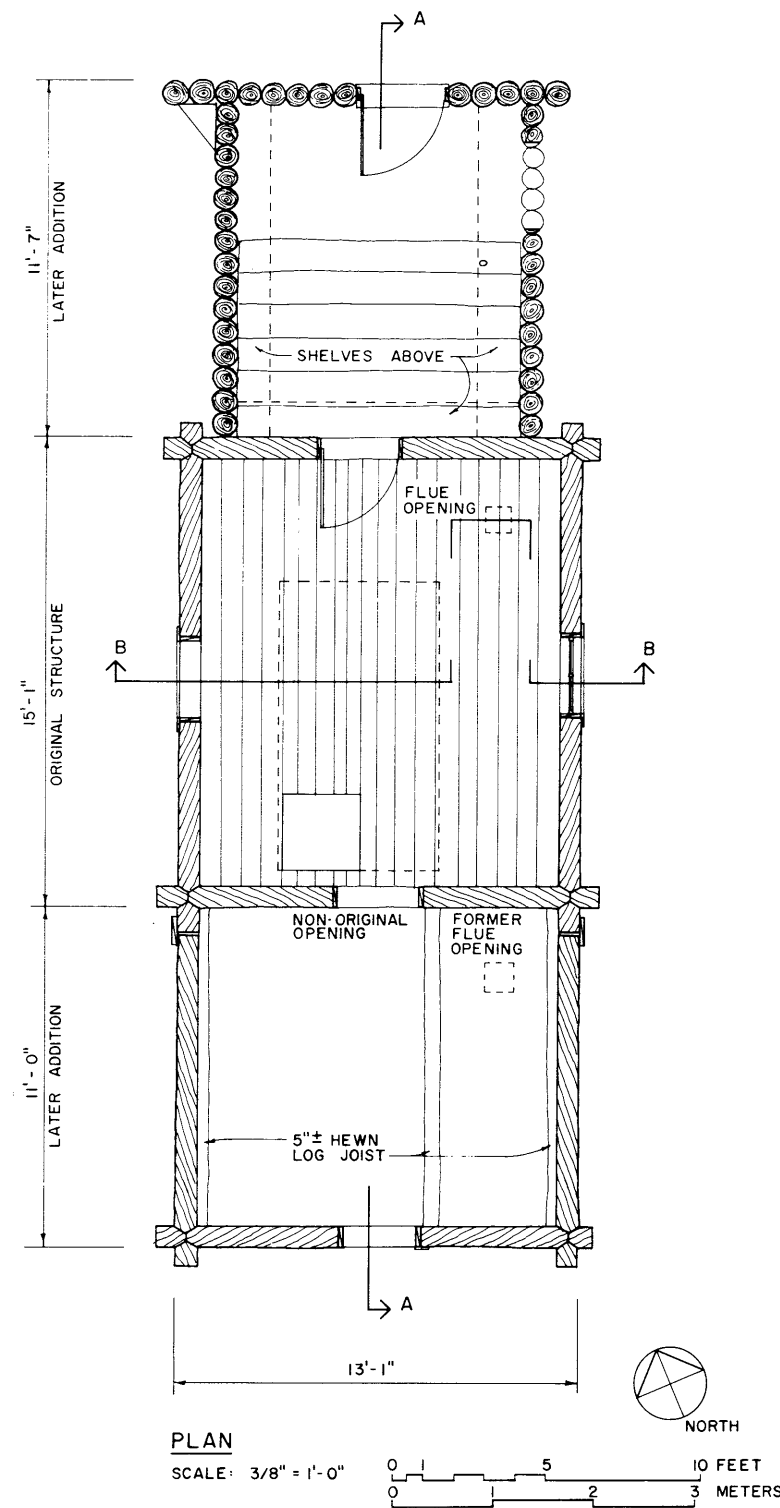

MATERIALS NOTE

ORIGINAL STRUCTURE:
 WALLS: 8"± V-NOTCHED LOGS, HEWN ON INTERIOR. MOSS AND SANDY CLAY CHINKING. MEAL BAGS AND CANVAS COVERING.
 FLOOR: 1 1/4" X VARIOUS WIDTH PLANKS.
 CEILING: MEAL BAGS AND CANVAS. TARPAPER AT FLUE OPENING.
 ROOF: CORRUGATED METAL OVER 5"± HEWN LOGS WITH MOSS INFILL.

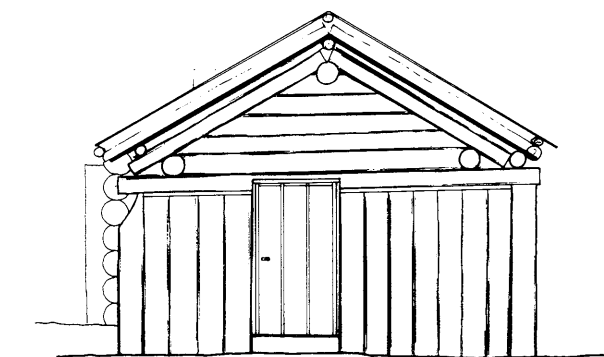

NORTH ELEVATION



SOUTH ELEVATION

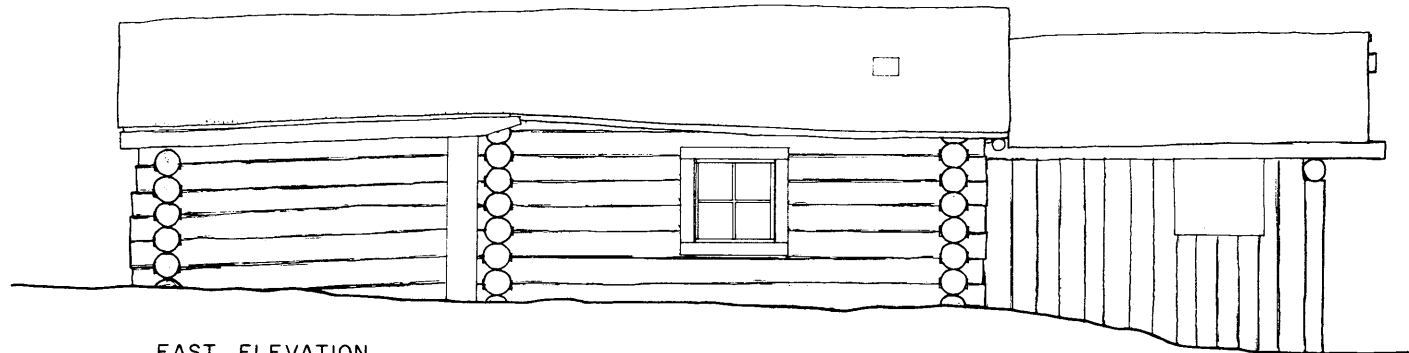

EAST ELEVATION

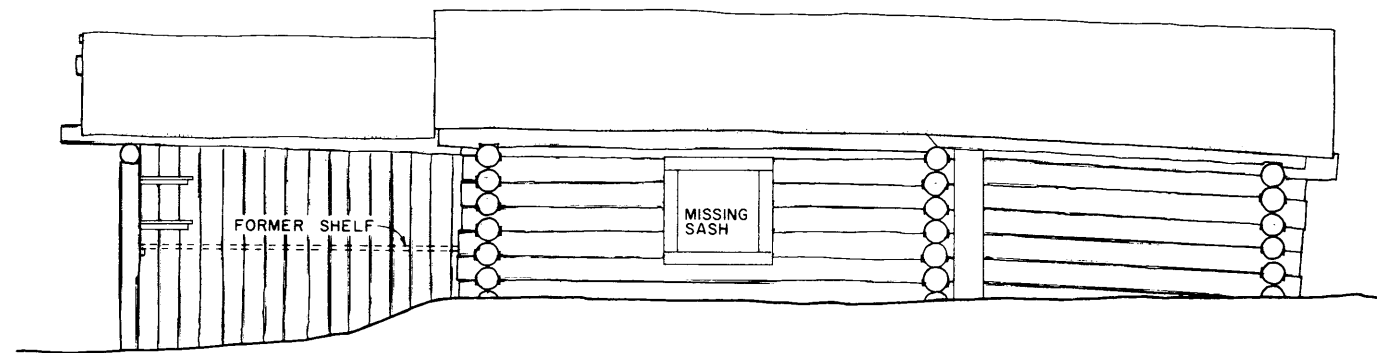

WEST ELEVATION

FRONT ADDITION:
 WALLS: 6"± DRIFTWOOD LOGS. MOSS AND SANDY CLAY CHINKING.
 FLOOR: 12"± HEWN LOGS AND DIRT.
 CEILING: UNFINISHED
 ROOF: CORRUGATED METAL OVER 5"± LOGS.

REAR ADDITION:
 ALL MATERIALS IDENTICAL TO ORIGINAL STRUCTURE EXCEPT FORMER WOOD FLOOR IS MISSING. (DIRT FLOOR)

DESIGNED BY: R. COPELAND

NATIONAL ARCHITECTURAL AND ENGINEERING RECORD
 NATIONAL HISTORIC SERVICE
 UNITED STATES DEPARTMENT OF THE INTERIOR

NAME AND LOCATION OF STRUCTURE

PORTAGE SHELTER CABIN

IDITAROD NATIONAL HISTORIC TRAIL

ALASKA

SURVEY NO.

HISTORIC AMERICAN BUILDINGS SURVEY

SHEET 7 OF 9 SHEETS

UNIVERSITY OF ALASKA

UNIVERSITY OF ALASKA

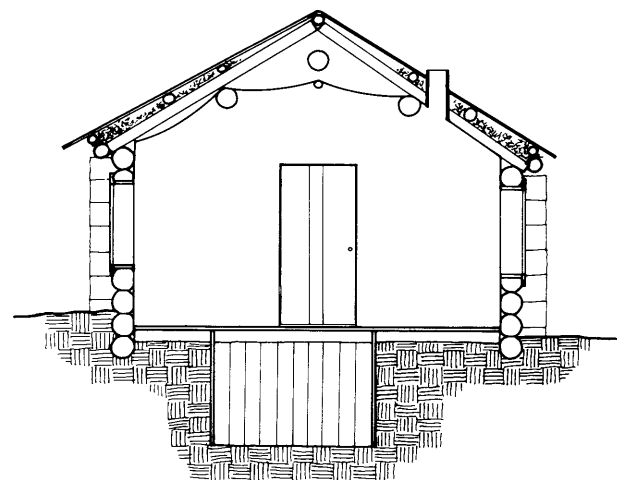

SECTION AA

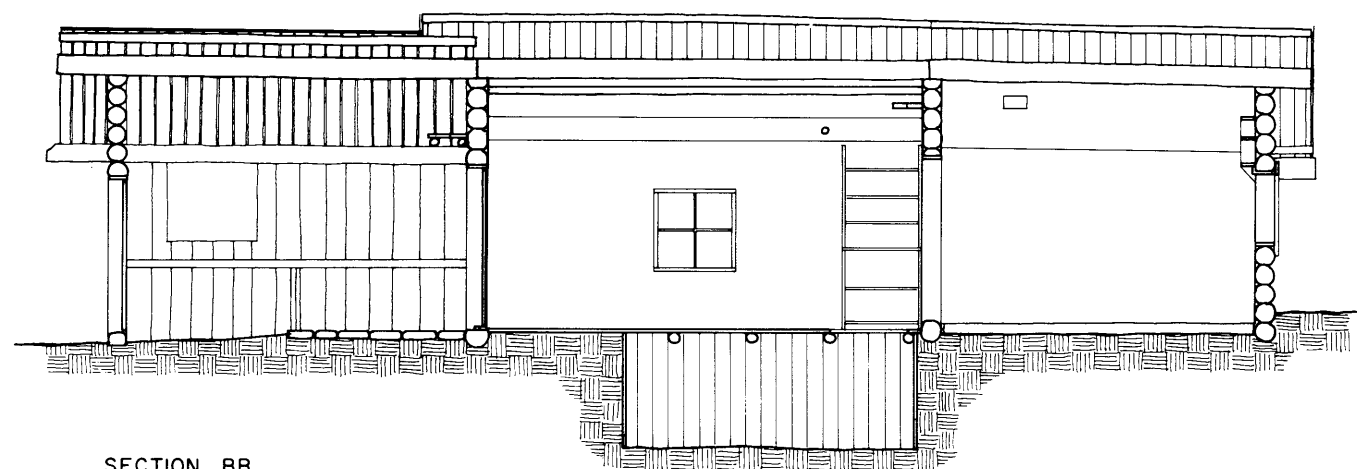

SECTION BB

SCALE: 3/8" = 1'-0"

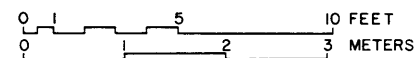

DRAWN BY: R. COPELAND

NATIONAL ARCHITECTURAL AND ENGINEERING RECORD
NATIONAL ARCHITECTURAL AND ENGINEERING RECORD
UNITED STATES DEPARTMENT OF THE INTERIOR

IDITAROD NATIONAL HISTORIC TRAIL

PORTAGE SHELTER CABIN

ALASKA

SHEET NO.

HISTORIC AMERICAN
BUILDINGS SURVEY
SHEET 8 OF 9 SHEETS

DATE OF SHEET
1981

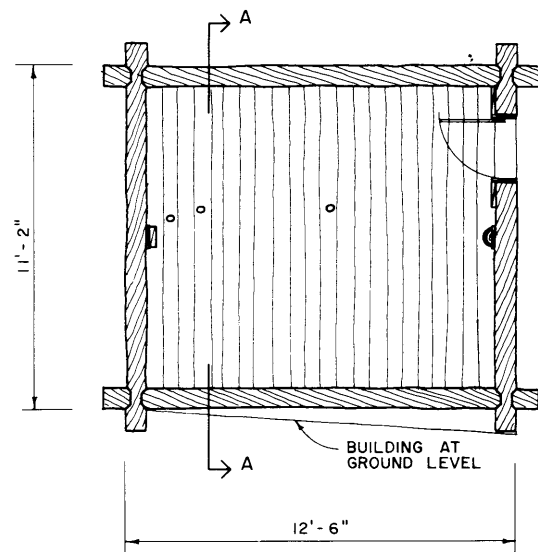

CACHE #1 PLAN (RUIN)
SCALE: 3/8" = 1'-0"

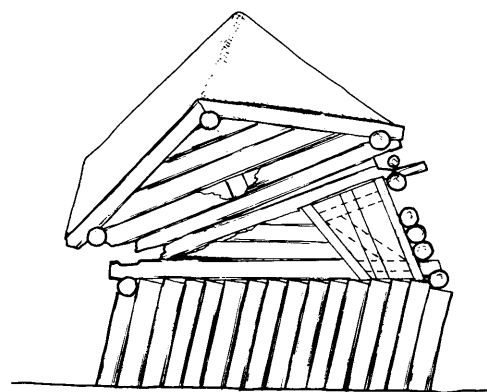

EAST ELEVATION

MATERIALS NOTE

WALLS: 9"± V-NOTCHED LOGS ON 10"± VERTICAL LOGS. MOSS CHINKING.
FLOOR: 6"± LOGS, NOTCHED AT WALLS.
CEILING: UNFINISHED.
ROOF: CORRUGATED METAL OVER 4"± LOGS.

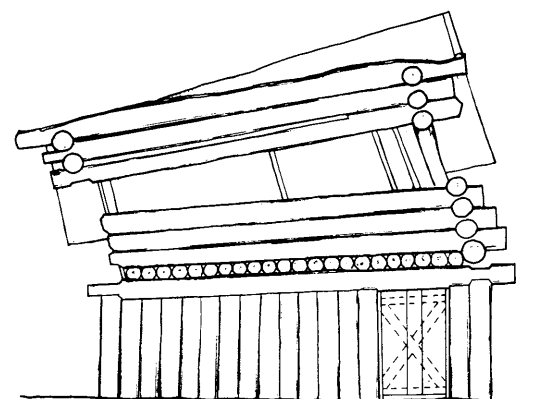

NORTH ELEVATION

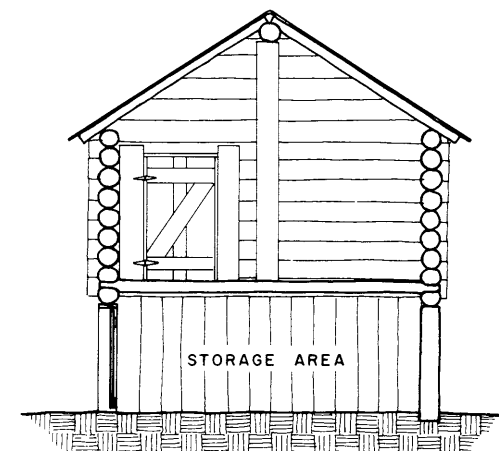

SECTION AA
ORIGINAL CONSTRUCTION BASED UPON REMAINING EVIDENCE.

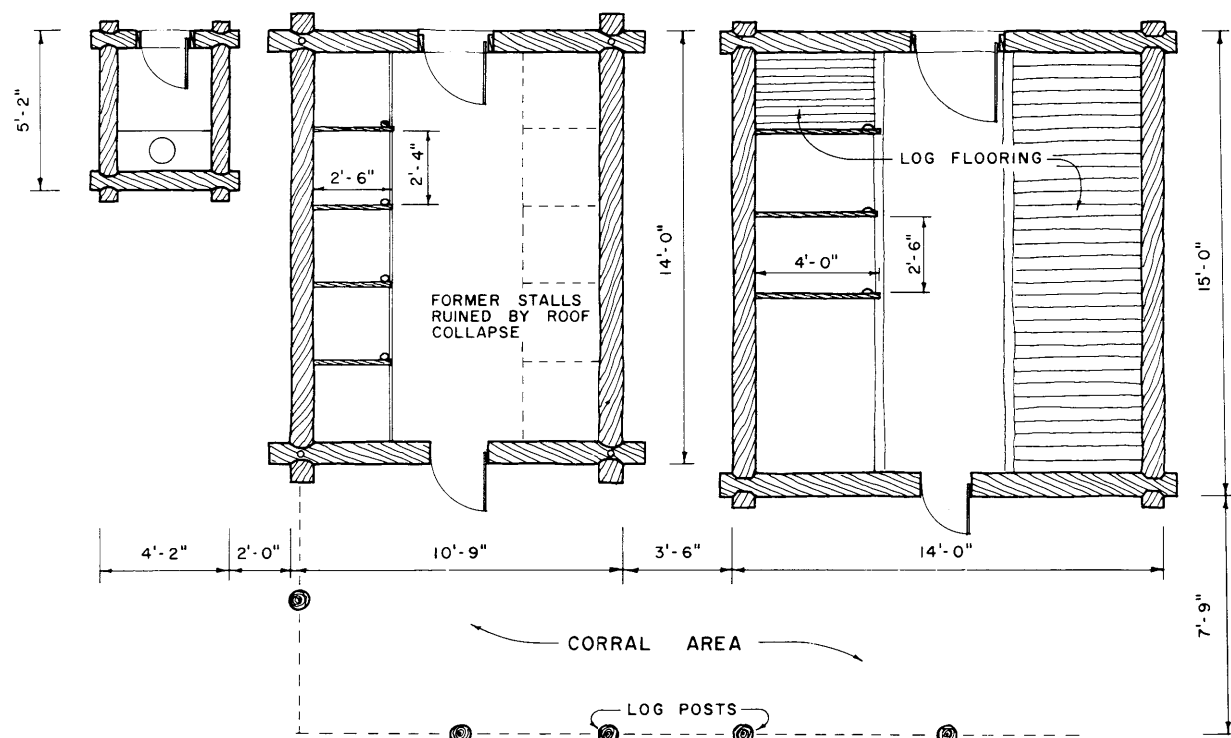

OUTHOUSE / DOGHOUSES PLAN (RUINS)

SCALE: 3/8" = 1'-0"
0 1 5 10 FEET
0 1 2 3 METERS



MATERIALS NOTE

EAST DOGHOUSE:
WALLS: 9"± V-NOTCHED LOGS. MOSS CHINKING.
STALL PARTITIONS: 3"± LOGS ON 4"± HEWN LOGS.
FLOOR: 4"± SPLIT LOGS AND DIRT.
CEILING: UNFINISHED.
ROOF: 6"± LOGS. MOSS CHINKING.

WEST DOGHOUSE:
WALLS: 9"± SADDLE-NOTCHED AND PINNED LOGS. MOSS CHINKING.
STALL PARTITIONS: 3"± LOGS ON 4"± LOGS.

FLOOR: DIRT.
CEILING: UNFINISHED.
ROOF: 6"± LOGS. MOSS CHINKING.

OUTHOUSE:
WALLS: 7"± SADDLE-NOTCHED LOGS. MOSS CHINKING.
FLOOR: DIRT.
CEILING: UNFINISHED.
ROOF: 4"± LOGS. MOSS CHINKING.

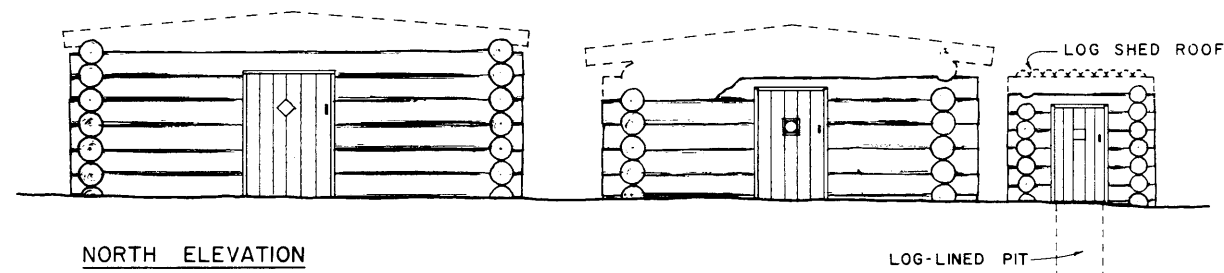

NORTH ELEVATION

DASHED LINES INDICATE SUSPECTED HEIGHT AND ROOFLINE BASED UPON FALLEN LOGS.

DRAWN BY: R. COPELAND

NATIONAL ARCHITECTURAL AND ENGINEERING RECORD
MEMBER OF THE
UNITED STATES DEPARTMENT OF THE INTERIOR

IDITAROD NATIONAL HISTORIC TRAIL

PORTAGE OUTBUILDINGS

ALASKA

HISTORIC AMERICAN
BUILDINGS SURVEY
SHEET 9 OF 9 SHEETS

SCALE OF SHEETS
SHEET 1 OF 9