

REV	DATE	REVISIONS	BY	CHECKED BY	PROJ. MANAGER	CUST. APPROVAL
4B	5/21/04	Compressor station sites for initial annual average capacity of 4,500 MMSCFD added; MP 0.0 to MP 1.0 realigned for Point of Origin relocation.	EG	PAC	KM	
4A	5/13/02	Compiled and recreated in digital form based on rev. 3 Ownership sheets, rev. 3 Civil sheets, and rev. 4 Pipeline sheets. Land ownership updated. Background map changed to USGS quads.	IWM	MTA	MRF	

ALASKAN NORTHWEST
NATURAL GAS TRANSPORTATION CO.

Baker
Michael Baker Jr., Inc.
A Unit of Michael Baker Corporation
4601 Business Park Blvd., Suite 42
Anchorage, Alaska 99503
Phone: (907) 273-1600
Fax: (907) 273-1699

This document is the property of the Alaskan Northwest Natural Gas Transportation Company (ANNATC), a partnership, or one or more of its associated companies. It contains proprietary and confidential information. The unauthorized use, reproduction, and/or disclosure of this information is prohibited pursuant to AS 40.25.120(a)(4) and by applicable State and Federal laws including, but not limited to: the Alaska Land Act, AS 38.05.035(a)(9); Article I, Section 22 of the Alaska Constitution; the Federal Trade Secrets Act, 18 USC § 1905; and the Federal Freedom of Information Act, Exemption 4, 5 USC 552(b)(4). Public access to this document also may be limited by the Federal Energy Regulatory Commission Statement of Policy on Treatment of Previously Public Documents, 37 FR 61 030 (2001). In addition, this document is protected as an unpublished work under the United States Copyright Law, 17 USC § 101 et seq. All rights are reserved; unauthorized reproduction is prohibited. ANNATC should be provided with written notice of any request for this document (other than a request from a State agency or official), as well as a reasonable opportunity to object to any proposed release of this document.

NATURAL GAS PIPELINE

LAND USE AND OWNERSHIP

M.P. 734.87 to M.P. 740.74

ALASKA SEGMENT OF THE
ALASKA NATURAL GAS TRANSPORTATION SYSTEM

0 500 1,000 2,000 3,000 4,000 Feet

DRAWING NO.:
4680-16-00-B-O-130

REV.:
4

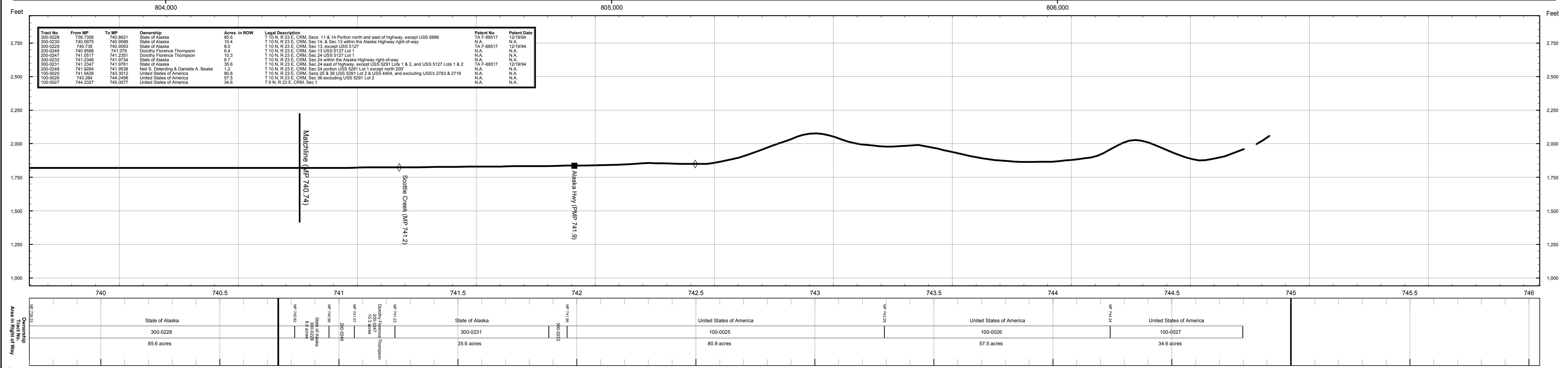
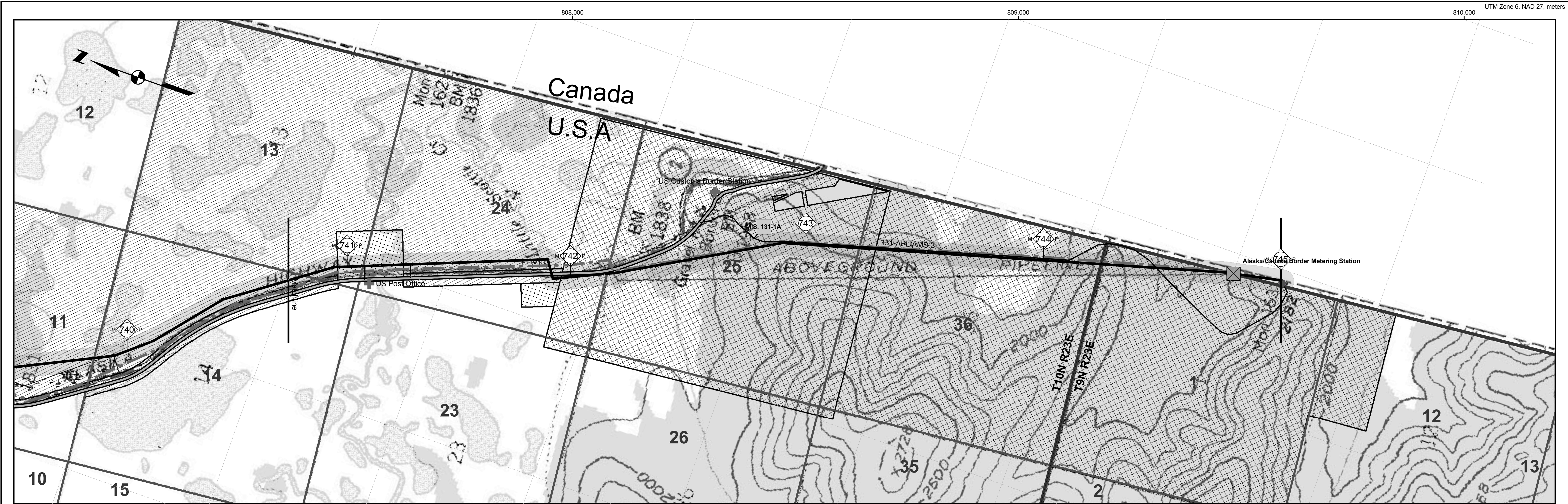

Milepost: 740 740.5 741 741.5 742 742.5 743 743.5 744 744.5 745 745.5 746

State of Alaska
300-0228
85.6 acres

State of Alaska
300-0228
10.3 acres

State of Alaska
200-0246
6.4 acres

Dorothy Florence Thompson
10.3 acres

State of Alaska
300-0231
35.6 acres

United States of America
100-0025
80.8 acres

United States of America
100-0026
57.5 acres

United States of America
100-0027
34.6 acres

Proposed Centreline

- Storage Yards
- Compressor Stations
- Material Sites
- River Staging Areas
- Access Roads

TAPS Oil Pipeline

- Other Pipelines
- Powerlines
- State Highways
- Airports
- Camps
- Landmarks
- Selected Wetlands

Land Ownership

- Federal (100)
- Federal: COE (1CE)
- Private (200)
- State (300)
- State: MHT (3MH)
- State: UA (3UA)
- Borough (400)

REV	DATE	REVISIONS	BY	CHECKED BY	PROJ. MANAGER	CUST. APPROVAL
4B	5/21/04	Compressor station sites for initial annual average capacity of 4,500 MMSCFD added; MP 0.0 to MP 1.0 realigned for Point of Origin relocation.	EG	PAC	KM	
4A	5/13/02	Compiled and recreated in digital form based on rev. 3 Ownership sheets, rev. 3 Civil sheets, and rev. 4 Pipeline sheets. Land ownership updated. Background map changed to USGS quads.	IWM	MTA	MRF	

**ALASKAN NORTHWEST
NATURAL GAS TRANSPORTATION CO.**

Baker
Michael Baker Jr., Inc.
A Unit of Michael Baker Corporation
4601 Business Park Blvd., Suite 42
Anchorage, Alaska 99503
Phone: (907) 273-1600
Fax: (907) 273-1699

This document is the property of the Alaskan Northwest Natural Gas Transportation Company (ANNATC), a partnership, or one or more of its associated companies. It contains proprietary and confidential information. The unauthorized use, reproduction, and/or disclosure of this information is prohibited pursuant to AS 40.25.120(a)(4) and by applicable State and Federal laws including, but not limited to: the Alaska Land Act, AS 38.05.035(a)(9); Article I, Section 22 of the Alaska Constitution; the Federal Trade Secrets Act, 18 USC § 1905; and the Federal Freedom of Information Act, Exemption 4, 5 USC 552(b)(4). Public access to this document also may be limited by the Federal Energy Regulatory Commission Statement of Policy on Treatment of Previously Public Documents, 37 FR 61.030 (2001). In addition, this document is protected as an unpublished work under the United States Copyright Law, 17 USC § 101 et seq. All rights are reserved; unauthorized reproduction is prohibited. ANNATC should be provided with written notice of any request for this document (other than a request from a State agency or official), as well as a reasonable opportunity to object to any proposed release of this document.

NATURAL GAS PIPELINE

LAND USE AND OWNERSHIP

M.P. 740.74 to M.P. 745.00

**ALASKA SEGMENT OF THE
ALASKA NATURAL GAS TRANSPORTATION SYSTEM**

0 500 1,000 2,000 3,000 4,000 Feet

DRAWING NO.: 4680-16-00-B-O-131

REV.: 4