

August 2002



# Point Thomson Gas Cycling Project

## Site Information

**ExxonMobil**

On behalf of the Point Thomson Unit owners

**ExxonMobil**

# Pt Thomson Unit Area

UTM 6 NAD 27 Projection

1:140,000

1 0.5 0 1 2 3 Miles

Digital Photo Mosaic from July 12, 1998 1" = 3,000' Natural Color Photography

70°15'0"N

## Legend

- Proposed Export Pipeline
- Proposed Infield Pipelines
- Proposed Gravel



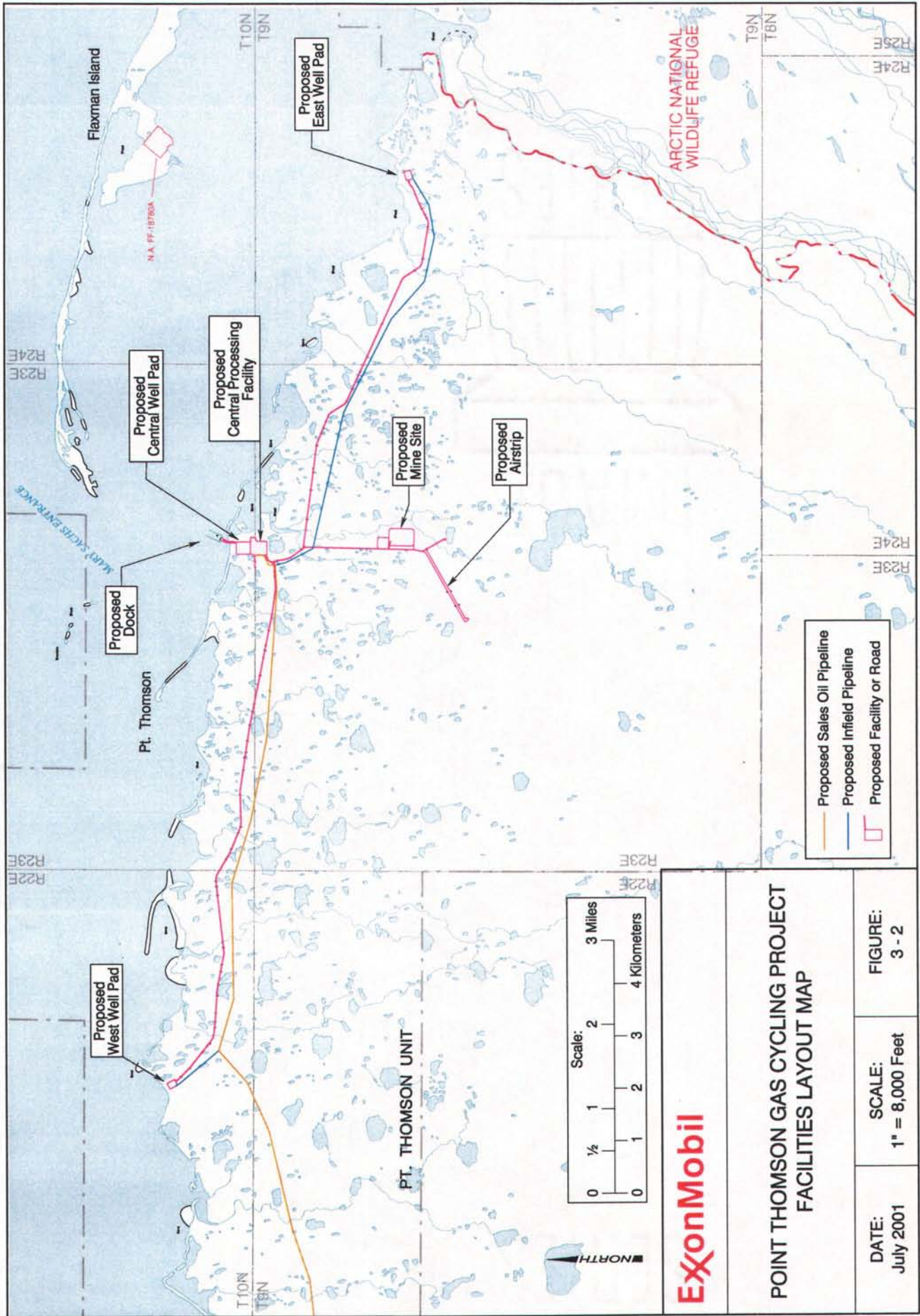

	Proposed Sales Oil Pipeline
	Proposed Infield Pipeline
	Proposed Facility or Road

**ExxonMobil**

**POINT THOMSON GAS CYCLING PROJECT  
FACILITIES LAYOUT MAP**

<b>DATE:</b> July 2001	<b>SCALE:</b> 1" = 8,000 Feet	<b>FIGURE:</b> 3 - 2
---------------------------	----------------------------------	-------------------------

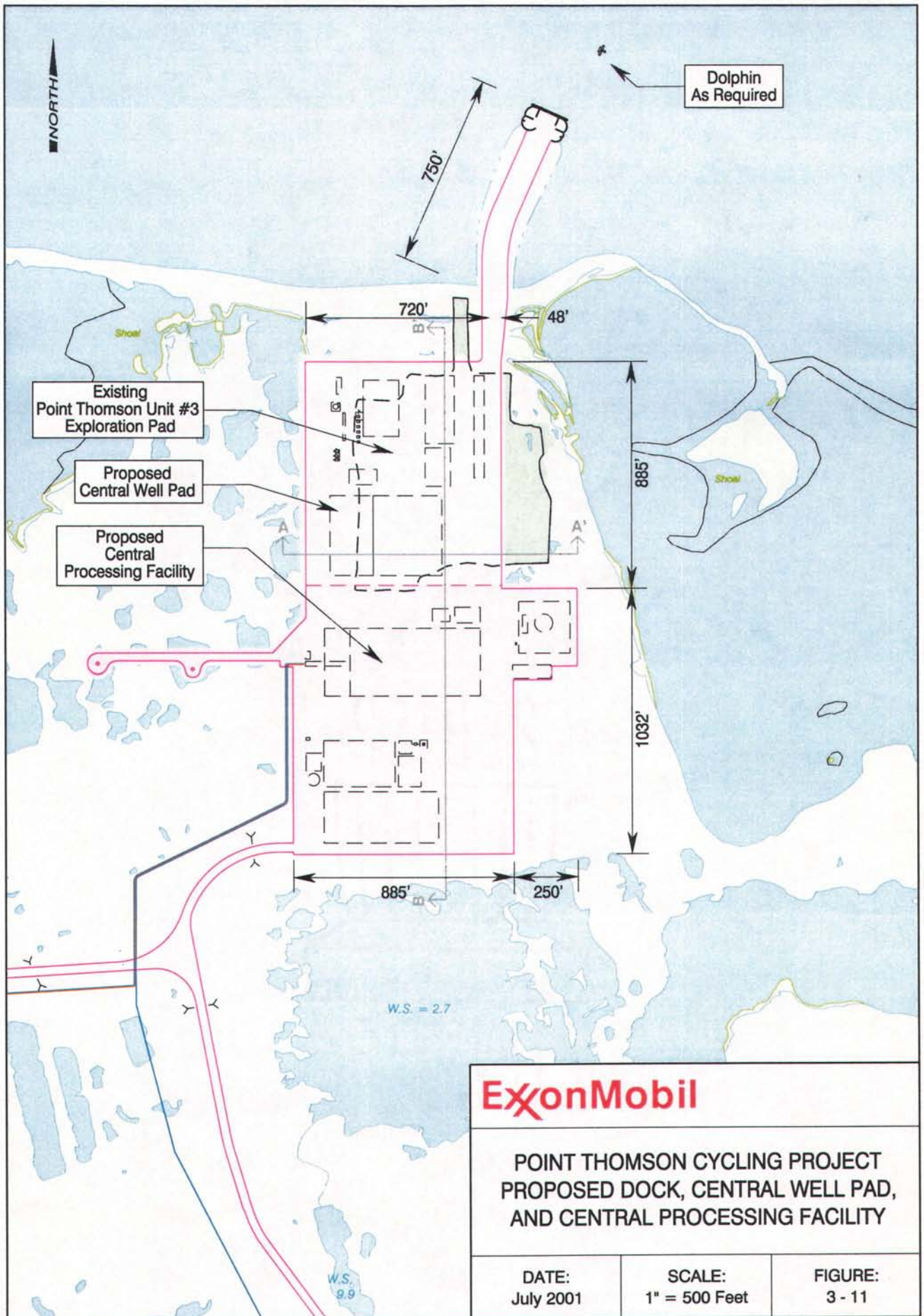





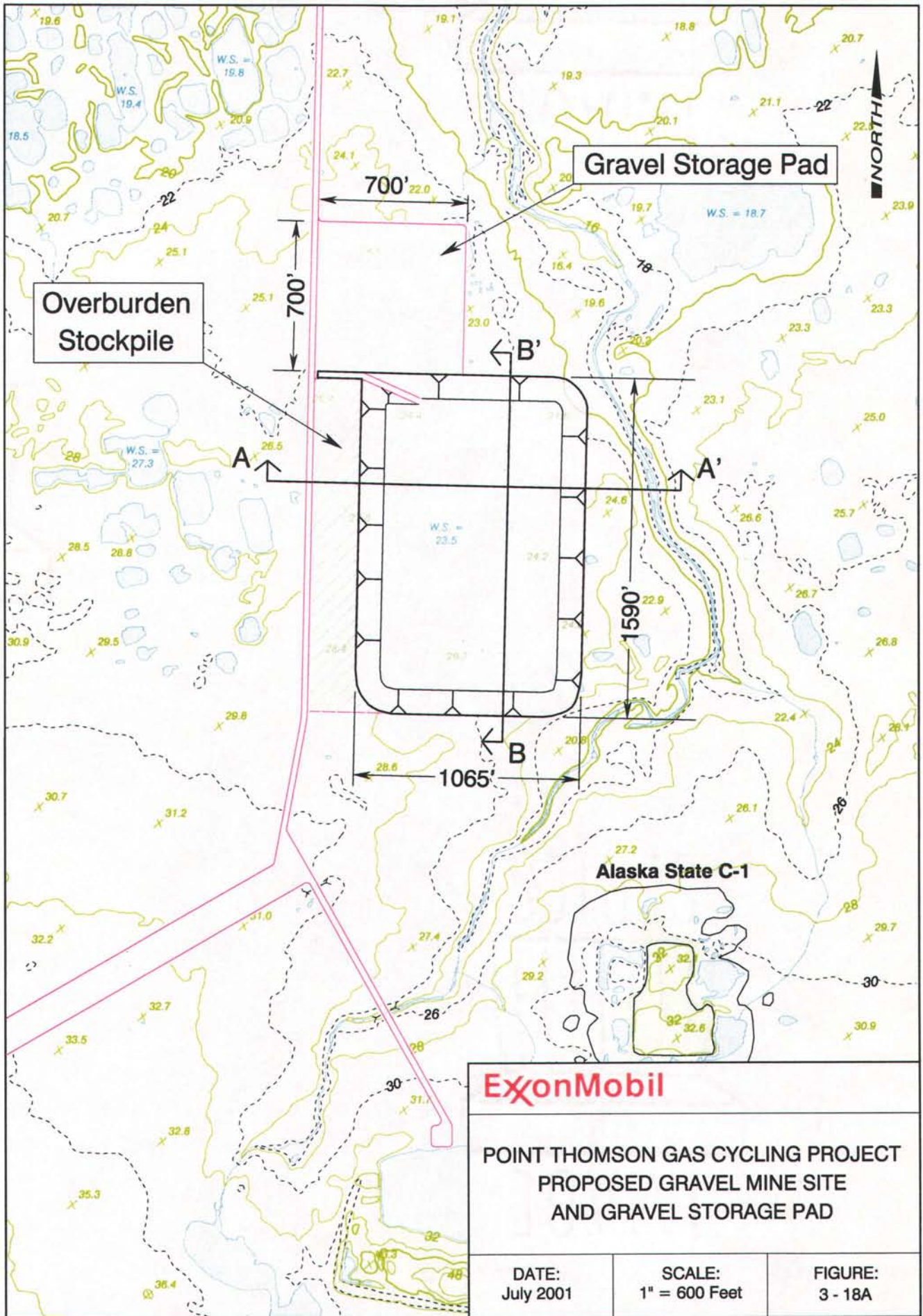



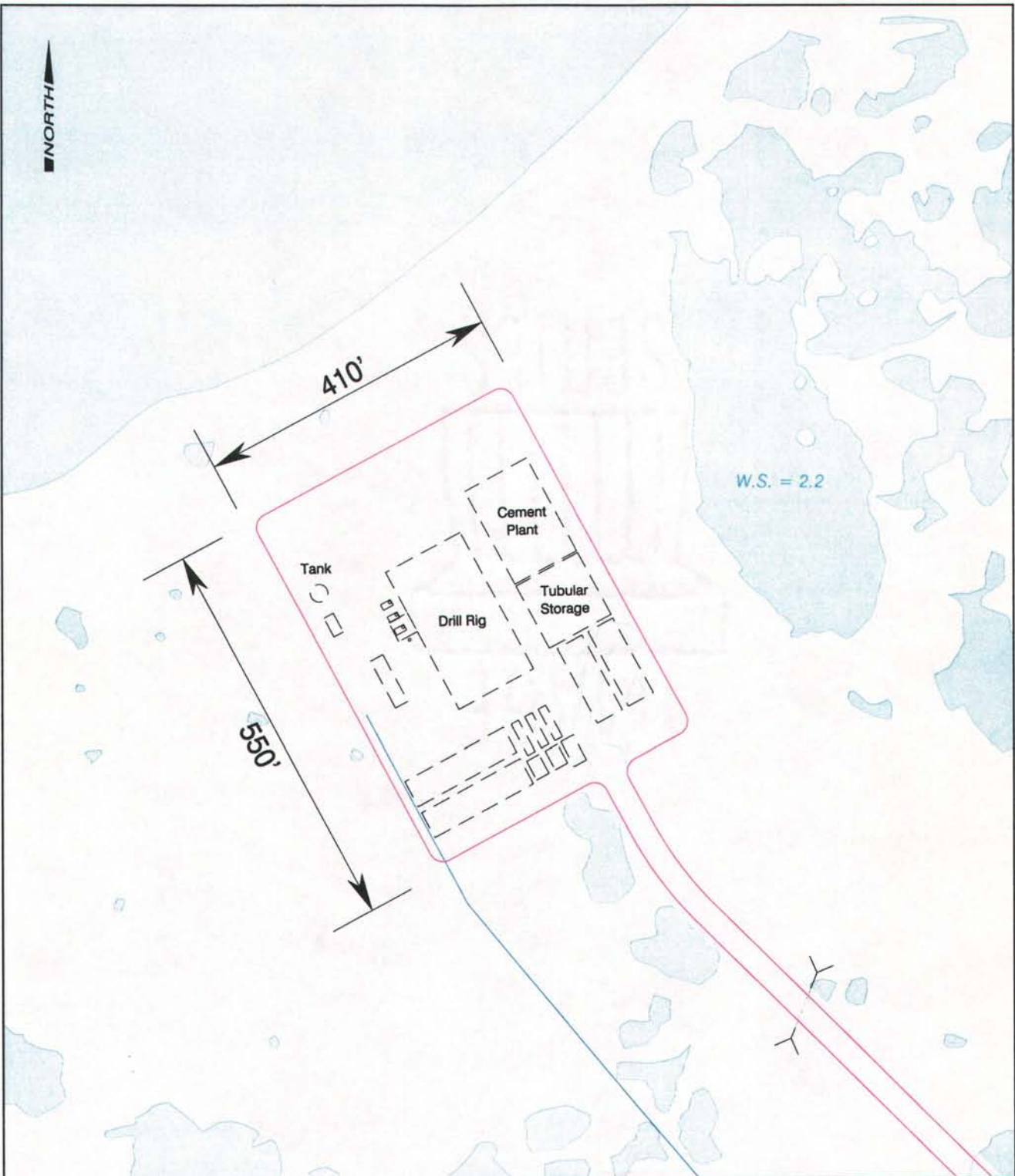

FACILITY PLACEMENT AND DIMENSIONS ARE APPROXIMATE

<b>ExxonMobil</b>		
<b>POINT THOMSON GAS CYCLING PROJECT WEST WELL PAD</b>		
DATE: July 2001	SCALE: 1" = 200 Feet	FIGURE: 3-17

---

# **Point Thomson Gas Cycling Project**

**EPA Administrator**

**Christie Whitman Alaska Visit**

**August 2002**

**ExxonMobil**

# ExxonMobil Organization

## Exxon Mobil Corporation

### Upstream

Exploration

Development

Production

Gas Marketing

ExxonMobil  
Upstream Research  
Company

### Downstream

Refining & Supply

Fuels Marketing

Lubricants & Pet. Specialties

ExxonMobil  
Research & Engineering  
Company

### Chemical

Basic Chemicals

Intermediates

Polymers and Film

Chemical  
Research &  
Engineering

**ExxonMobil**

# ExxonMobil Project Portfolio

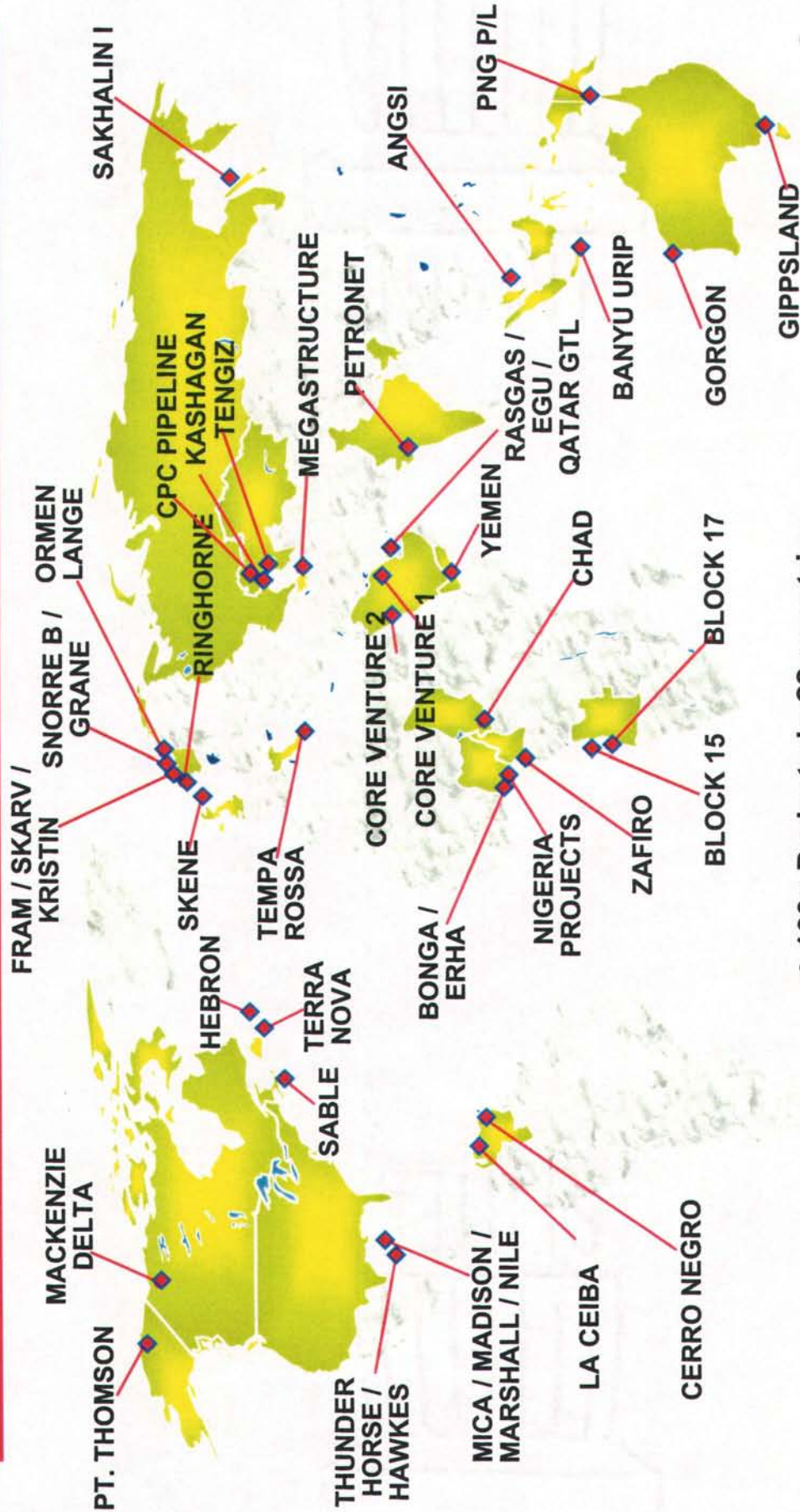

- 100+ Projects in 22 countries
- Annual managed capex \$6-9G (gross operated + net OBO)

# Point Thomson Overview

---

- Point Thomson Unit comprised of 43 individual leases on 116,724 acres
- Located 45 miles east of Prudhoe Bay, 22 miles east of Badami
- Principal owners are ExxonMobil (operator), BP, ChevronTexaco & Phillips
- 14 wells drilled to Thomson reservoir
- Reserve estimates: - 8 trillion cubic feet of gas  
- 400+ million barrels of condensate

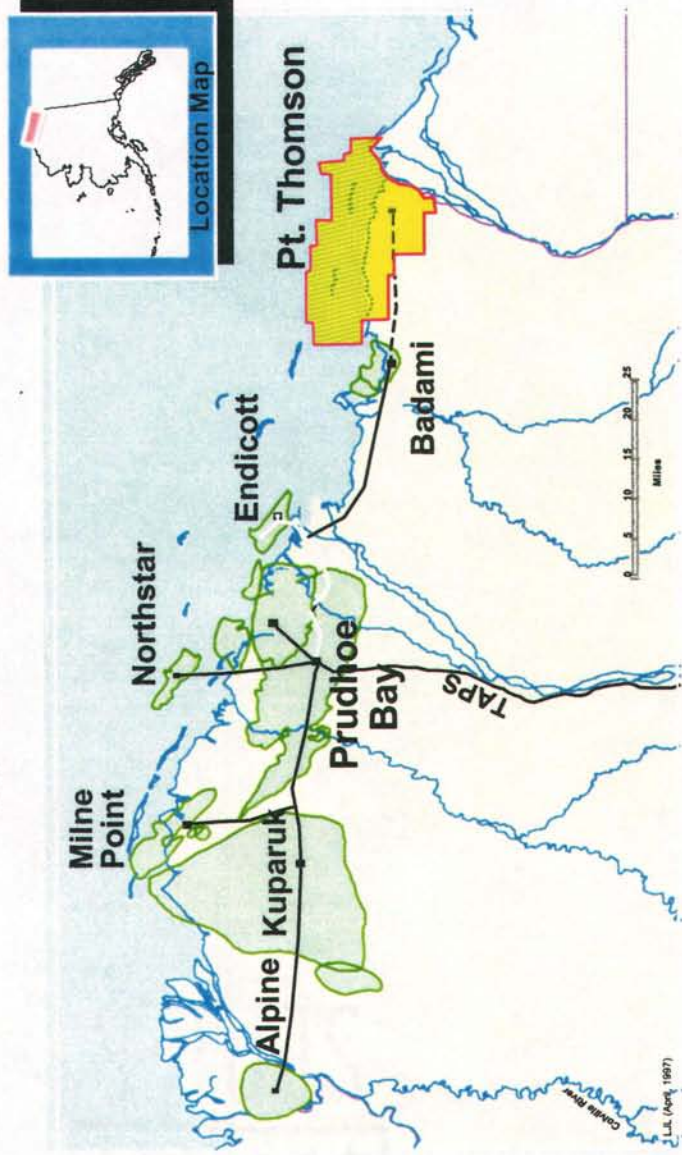

# Gas Cycling Project Scope

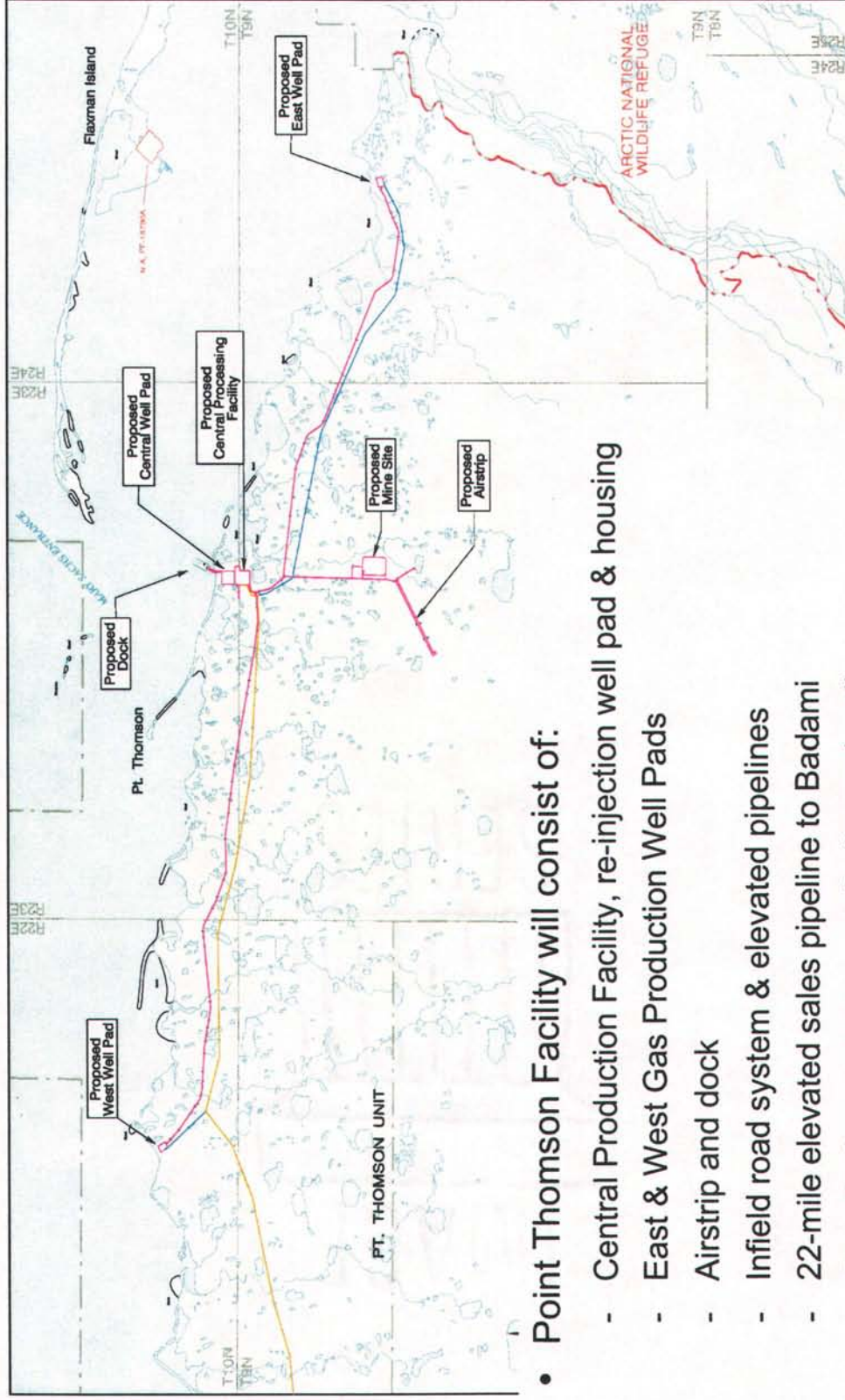
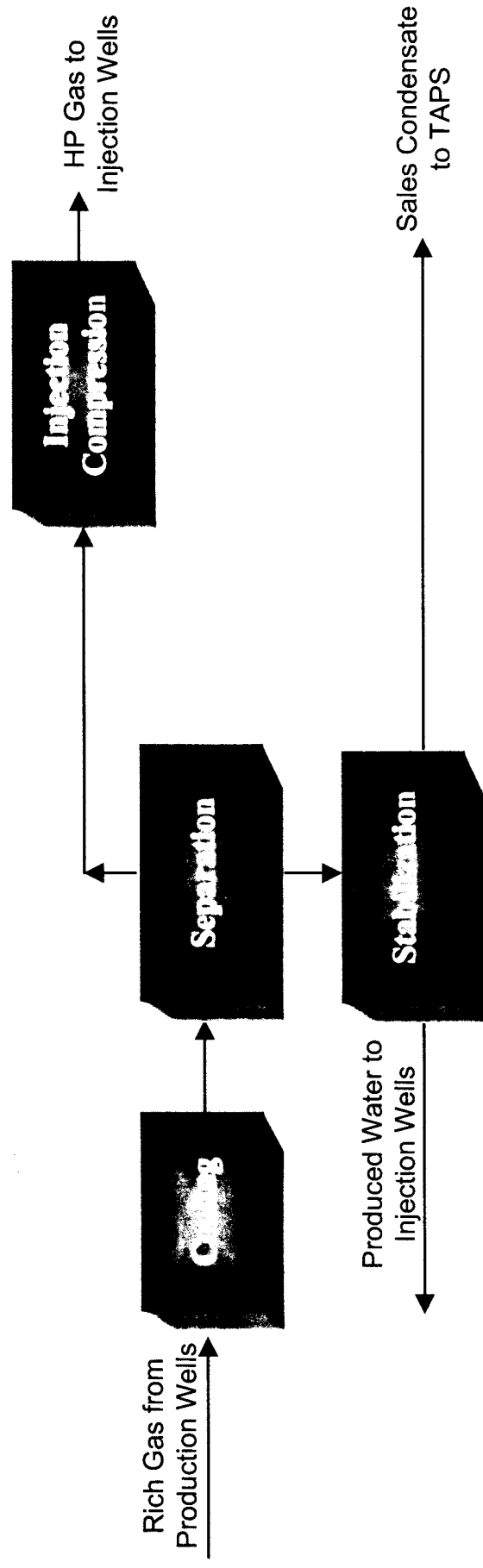

Fig3\_2a.pdf

- Point Thomson Facility will consist of:
  - Central Production Facility, re-injection well pad & housing
  - East & West Gas Production Well Pads
  - Airstrip and dock
  - Infield road system & elevated pipelines
  - 22-mile elevated sales pipeline to Badami
  - Gravel mine, water source & disposal well

# Gas Cycling Process

---



- Gas is produced from the reservoir
  - + Typical well rates will be > 100 million cubic feet per day
- Condensate is extracted from the gas
- Condensate is shipped to market
- Dry gas is injected back into the reservoir for pressure maintenance & future use
  - + Thomson reservoir requires > 10,000 psi injection pressure

# **Gas Cycling Project Overview**

---

- Final development decision expected 2003 - 2004 after permits obtained
- If approved by owners, project start-up anticipated in 1Q 2007
- Peak production expected to be 75,000 bbls of condensate per day
- Economic Impact:
  - Project cost expected to exceed \$1 billion
  - Preliminary estimate of 450 construction jobs at peak and about 50 operations jobs
  - Contractor opportunities for Alaska and Native Corporations
  - Government revenues through royalty and taxes

# Gas Cycling Project Timeline

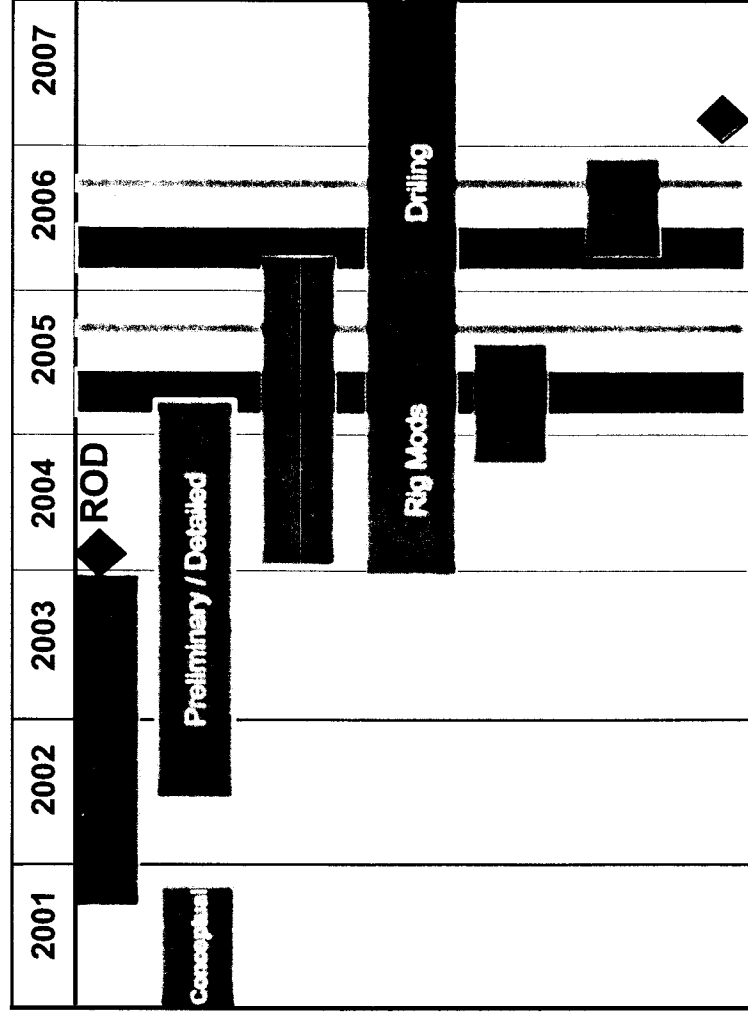

Ice Road Available  
Sea Access

- Timing of ROD important because one-month delay may translate to a one-year or more delay due to narrow weather window

# **Environmental Overview**

- Completed and filed environmental report with federal, state, and local agencies on July 31, 2001
  - Prepared as a precursor for the Environmental Impact Statement (EIS)
  - Contains project description as currently conceived, reference on previous studies
  - Describes projected environmental impacts and proposed mitigating measures
    - e.g. Caribou, Polar Bears, endangered species, project “footprint”, and Proximity to ANWR
  - Addendum responding to agency comments recently released
- Section 404 permit application to the Corps of Engineers filed in August 2001
- Notified that EPA assumed role of lead agency for EIS in December 2001
- Notice Of Intent for EIS published in Federal Register April 19, 2002
- EIS process Memorandum of Agreement with EPA - June 2002
- Third-party contractor selection underway, target completion by end of August